



HE whom this scroll commemorates was numbered among those who, at the call of King and Country, left all that was dear to them, endured hardness, faced danger, and finally passed out of the sight of men by the path of duty and self-sacrifice, giving up their own lives that others might live in freedom. Let those who come after see to it that his name be not forgotten.

203145, PRIVATE, Robert BREAKELL

1/4th Battalion (Territorial Force).

Loyal North Lancashire Regiment

Killed in action, France & Flanders, 31/07/17

Enlisted: Preston, Residence: Longton, Lancs

**In Memory of
Private R BREAKELL**

**203145, 1st/4th Bn.,
The Loyal North Lancashire Regiment**

who died on 31 July 1917

**Remembered with honour
NEW IRISH FARM CEMETERY**



**Commemorated in perpetuity by
the Commonwealth War Graves Commission**

Name: BREAKELL

Initials: R

Nationality: United Kingdom

Rank: Private

Regiment/Service: The Loyal North Lancashire Regiment

Unit Text: 1st/4th Bn.

Date of Death: 31/07/1917

Service No: 203145

Casualty Type: Commonwealth War Dead

Grave/Memorial Reference: IV. A. 15.

Cemetery: [NEW IRISH FARM CEMETERY](#)

Cemetery: NEW IRISH FARM CEMETERY

Country: Belgium

Locality: unspecified

Visiting Information: Wheelchair access to site possible, but may be by an alternative entrance. For further information regarding wheelchair access, please contact our Enquiries Section on telephone number 01628 507200

Location Information: The cemetery is located to the north-east of the town of Ieper. From the station turn left and follow along M Fochlaan to the roundabout. Turn right and at the next roundabout turn left into M Haiglaan. Follow along this road to the traffic lights and at the lights turn right in the direction of Kortrijk (A19). Follow along the expressway to the next set of lights. At these lights turn left into Pilkemseweg, then take the first right into Zwaanhofweg, a small country road. Follow this road to the crossroads and the cemetery is on your right.

Historical Information: New Irish Farm Cemetery was first used from August to November 1917, and again in April and May 1918. At the Armistice it contained just 73 burials - the three irregular rows of Plot I - but was then greatly enlarged when more than 4,500 graves were brought in from the battlefields north-east of Ypres (now Ieper) and from numerous smaller cemeteries in the area. There are now 4,715 commonwealth servicemen of the First World War buried or commemorated in this cemetery. 3,267 of the burials are unidentified but special memorials commemorate four casualties known or believed to be buried among them. Other special memorials record the names of 30 casualties buried in four of the cemeteries concentrated into New Irish Farm whose graves were destroyed by shell fire. The cemetery was designed by Sir Reginald Blomfield.

No. of Identified Casualties: 1449

Cemetery Plans

NEW IRISH FARM CEMETERY

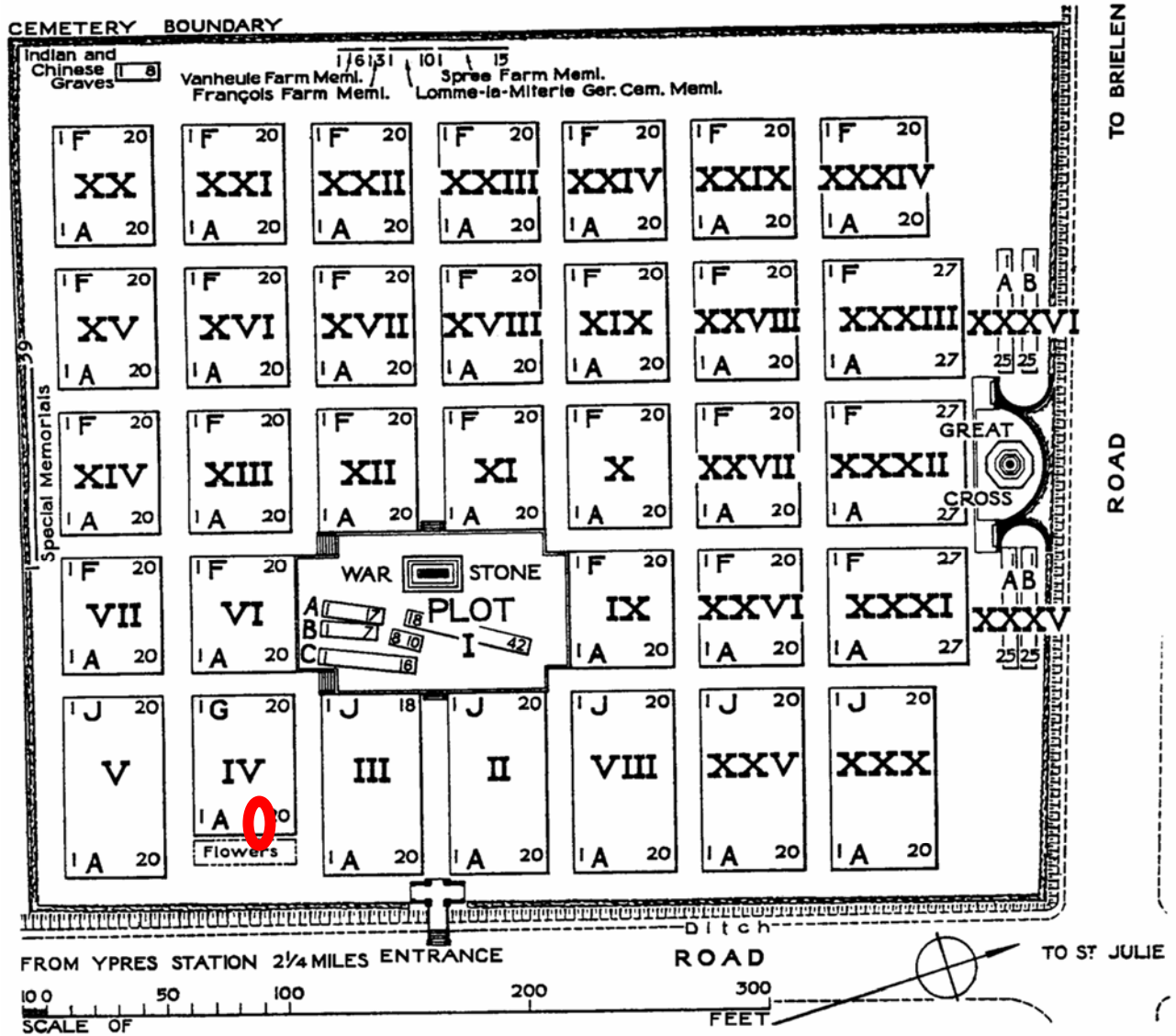

NEW IRISH FARM CEMETERY, ST. JEAN-LES-YPRES
 Private Robert Breakell's grave highlighted at IV. A. 15.



**Robert BREAKELL's grave at
New Irish Farm cemetery, Ieper,
Belgium, no. IV. A. 15.**

Private 203145 Robert BREAKELL

Preston Guardian

Page 10

8th September, 1917

Seventeen men from Longton have fallen in the war. Private R. Breakell of the Loyal North Lancs. Regt. Is now reported missing.

Preston Guardian

Page 5

8th June, 1918

Pte. Robert Breakell who has been missing since July last is posted "killed in action".

Penweortham St. Mary's Church Magazine

June 1919

Page v

We greatly regret that we have to add another name to the list of those who have given their lives for their Country. It is now known that Pte. Robert Breakell who has been reported missing since last July was killed in action. We tender our deepest sympathy to his widow and young family.

Name.	Corps.	Rank.	Regtl. No.
BREAKELL Robert.	L. Tr. Lan. R.	Pte	6913.
	— " —		203145

Medal.	Roll.	Page.	Remarks.
VICTORY	H/2/10/B22	3578.	
BRITISH	— do —	do.	
STAR			
Theatre of War first served in			
Date of entry therein			

K. 1380.

Correspondence.

Address.

The Medal Roll Card indicating the award of the Allied Victory and British War Medals to Private BREAKELL



The British War Medal 1914 – 1918

Established on 26th July 1919.

Also known as '*Squeak*'.

The silver or bronze medal was awarded to officers and men of the British and Imperial Forces who either entered a theatre of war or entered service overseas between 5th August 1914 and 11th November 1918 inclusive. This was later extended to services in Russia, Siberia and some other areas in 1919 and 1920.

Approximately 6.5 million British War Medals were issued.

Approximately 6.4 million of these were the silver versions of this medal.

Around 110,000 of a bronze version were issued mainly to Chinese, Maltese and Indian Labour Corps. The front (obv or obverse) of the medal depicts the head of George V.

The recipient's service number, rank, name and unit was impressed on the rim.



The Allied Victory Medal

Also known as '*Wilfred*'

It was decided that each of the allies should each issue their own bronze victory medal with a similar design, similar equivalent wording and identical ribbon.

The British medal was designed by W. McMillan. The front depicts a winged classical figure representing victory.

Approximately 5.7 million victory medals were issued. Interestingly, eligibility for this medal was more restrictive and not everyone who received the British War Medal ('Squeak') also received the Victory Medal ('Wilfred'). However, in general, all recipients of 'Wilfred' also received 'Squeak' and all recipients of 'Pip' also received both 'Squeak' and 'Wilfred'.

The recipient's service number, rank, name and unit was impressed on the rim.

Medals that were awarded to Private BREAKELL

Corps

RECRO SERVICE PAPER

For men deemed to be enlisted in H.M. Regular Forces for General Service with the Colours or in the Reserve for the period of the War, or Ex-Soldiers recalled for Service with the Colours, under the provisions of the Military Service Acts, 1916.

203145

No. Christian Names Robert Surname Breakell

Corps

Questions to be put to the Reservist on Joining.

- 1. What is your Name? ... 1. Christian Names Robert
- ... Surname Breakell
- 2. What is your full Address? ... 2. Chapel Lane, Long
- ... 3. Are you a British Subject? ... 3.
- 4. What is your Age? ... 4. 24 Years ... Months
- 5. What is your Trade or Calling? ... 5. Carpenter
- 6. Are you Married? ... 6.
- 7. Have you ever served in any branch of His Majesty's Forces, naval or military? If so*, which? ... 7.
- 8. Have you any preference for any particular branch of the service, if so, which? ... 8.
- 9. Are you desirous of serving in the Royal Navy, if so, state your qualifications. ... 9.

I, Robert Breakell do solemnly declare that the above answers made by me to the above questions are true.

Christian Names Robert Surname Breakell SIGNATURE OF RECRUIT.

Date 20 9 1916

Place Boston Signature of Witness.

EXEMPTION FROM COMBATANT SERVICE ON CONSCIENTIOUS GROUNDS.

If the Recruit has been exempted by a Tribunal on conscientious grounds from serving as a combatant it should be so stated here.

MEDICAL CLASSIFICATION AS TO FITNESS FOR SERVICE ON JOINING.

Classification

* To be filled in by the Recruiting Officer after Classification by the Medical Board.

Certificate of Approving Officer.

I approve the acceptance of the above-named man and appoint him to the

Date 20/9/16 Place Boston Approving Officer.

† The signature of the Approving Officer is to be affixed in the presence of the Recruit. ‡ Here insert the "Corps" to which the Recruit has been appointed.

* If so, the Recruit is to be asked the particulars of his former service, and to produce, if possible, his Certificate of Discharge and Certificate of Character which should be returned to him conspicuously endorsed in red ink, as follows, viz. (Name) on the (Date) enrolled in the (Regiment).

DESCRIPTIVE REPORT ON JOINING.

(To correspond with Entries on the Military History Sheet.)
Applicable to all

Christian Names Robert Surname Breakell
 Apparent age 34 years 0 months. Height 5 feet 3 inches.
 Chest Measurement { Girth when fully expanded 46 inches.
 Range of expansion 2 1/2 inches.
 Distinctive marks sc. b. 1. sh. 11

INFORMATION SUPPLIED BY RECRUIT

Address of next-of-kin Mrs. Breakell Relationship Wife
14 Chapel Lane, Longton, Derby.
 Particulars as to Marriage.

(a) Christian and Surname of Woman to whom married, and whether spinster or widow. (b) Place and date of marriage.
 (c) Present address. (d) Initials of Officer verifying entry.

(a) <u>Mrs. Breakell</u>	(b) <u>Not verified</u>	(c) <u>Not verified</u>	(d) <u>Not verified</u>
<u>Spinster</u>	<u>Not verified</u>	<u>Not verified</u>	<u>Not verified</u>

Particulars as to Children.

Christian Names	Date and Place of Birth.
<u>William Breakell</u> <u>John Breakell</u>	<u>Longton D.</u>

MILITARY HISTORY SHEET.

1. Passed classes of Instruction†		
† This includes any authorised class of instruction, e.g., in swimming, chiropody, &c.		
2. Campaigns ... (including Actions)	<u>Home 30/9/16 to 25.1.17</u> <u>France 26.1.17 to 31.7.17</u>	<u>Not verified</u>
3. Wounded ...	<u>Missing 31.7.17 Capt 1099 D.</u>	
4. Special instances of gallant conduct and mentions in public despatches		
5. Medals, decorations and annuities	Name of Medal,	Class
6. Injuries in or by the service		

STATEMENT of the SERVICES of No. 203175

Christian James Robert

Surname Breakell

Corps	Battn. or Depot	Promotions, Reductions, Casualties, &c	Army Rank	Dates	Service not allowed to reckon for fixing the rate of Pension		Signature of Officers certifying correctness of Entries
					years	days	
General Service		Deemed to have been enlisted		24-6-16			<i>[Signature]</i>
<i>Equal to</i>	<i>4th</i>	Called up for Service <i>Hosts</i>	<i>Pte.</i>	<i>1/10/16</i>			<i>[Signature]</i> ADJT. DEPOT. L. N. LANG. REGT.
	<i>1/4</i>	<i>Dead on service</i> <i>E/525774/1 dt. 10-5-18</i>	"	<i>31-7-17</i>			
Total Service forfeited as above ...							
Total Service towards Engagement to <i>31-7-17</i> (date of discharge)					years	<i>305</i>	days
" " " Pension " " " " " "							

Any further communication on this subject should be addressed to:—
The Secretary,
Ministry of Pensions
(Widows and Dependants Branch),
45, Grosvenor Road,
London, S.W. 1.
and the following number quoted.

MINISTRY OF PENSIONS

(Widows and Dependants Branch),

45, GROSVENOR ROAD,

LONDON, S.W. 1,

RECORDED
INFANT
HOUSE, STATION.

23.3.1918

No. 203145 (Rev.) (Wid)

SIR,

I am directed by the Minister of Pensions to inform you that the ^{wife} widow of No. 203145 Pat Robert Breakell ^(missing)
and L. H. Lewis
has been awarded a Pension of 28/9 a week, for herself and four children, with effect from the 25.3.18.

The Officer issuing Separation Allowance has been informed of the award.

The Pension will be paid from the Pension Issue Office.

The certificates received in support of the application have been returned to the widow.

I am, SIR,

Your obedient Servant,

Matthew Nathan

The Officer in Charge of Records

Secretary.

Private BREAKELL's widow's pension award

Army Form B. 103.

Attested on A.F. 23512
Casualty Form - Active Service.

Regimental Number 4/6915

Regiment or Corps 4th (Res.) Bn. L. N. I. Regt

B. 235129

Rank Pte Surname Breakell Christian Name Robert

Religion Church of England Age on Enlistment 34 years - months.

Enlisted (a) 30.9.16 Terms of Service (a) 12 months Service reckons from (a) 30.9.16

Date of promotion to present rank _____ Date of appointment to lance rank _____

Extended { _____ } Re-engaged { _____ } Qualification (b) _____
 or Corps Trade and Rate _____

Signature of Officer. _____

Report		Record of promotions, reductions, transfers, casualties, &c., during active service, as reported on Army Form B. 213, Army Form A. 36, or in other official documents. The authority to be quoted in each case.	Place of Casualty	Date of Casualty	Remarks Taken from Army Form B. 213, Army Form A. 36, or other official documents
Date	From whom received				
		Embarked ... <u>Tolchester</u>		<u>26-1-17</u>	
		Disembarked... <u>Boulogne</u>		<u>do.</u>	
<u>24-1-17</u>	<u>25 J. B. D.</u>	<u>Arrived</u>	<u>Etaples</u>	<u>24-1-17</u>	<u>From Regt</u>
<u>17-2-17</u>	<u>do</u>	<u>To HQ L. Gen. Hosp</u>	<u>do</u>	<u>13-2-17</u>	<u>B.213</u>
<u>1-2-17</u>	<u>B.C. No 4 Gen. Hosp</u>	<u>Adm. Influenza Sec.</u>	<u>Dannes Comin</u>	<u>do</u>	<u>H.A. 6821 W.3036</u>
<u>16-3-17</u>	<u>B.C. No 6 Con. Dep.</u>	<u>Adm. Influenza Sec.</u>	<u>Etaples</u>	<u>27-2-17</u>	<u>W.3034 H.A.7229</u>
<u>7-3-17</u>	<u>B.C. 258 B.D.</u>	<u>Adm. Influenza Sec.</u>	<u>Etaples</u>	<u>1-3-17</u>	<u>From Roll of Casuals</u>
<u>25-3-17</u>	<u>B.C. Bn.</u>	<u>Joined Bn.</u>	<u>Field</u>	<u>16-3-17</u>	<u>B.213</u>
Allotted Regt No UNDER A. C. I. '2414/16.					
<u>13-5-17</u>	<u>B.C. 5</u>	<u>197 Tunnelling Coy</u>	<u>Field</u>	<u>9-5-17</u>	<u>B.213</u>
<u>11-6-17</u>	<u>do.</u>	<u>Joined Bn.</u>	<u>do</u>	<u>11-6-17</u>	<u>B.213</u>
<u>4-8-17</u>	<u>B.C. 1/4 Bn.</u>	<u>Missing 31-7-17</u>			<u>B.213 01910-42</u>

(a) In the case of a man who has re-engaged for, or enlisted into Section D, Army Reserve, particulars of such re-engagement or enlistment will be entered.
 (b) Signaller, Shoeing-Smith, &c.

Private BREAKEL's record of service

MEMORANDUM FOR

L.N.P. 15/19
The Officer in charge of Infantry Records,
Preston.

Further communication on this
should be addressed to—
The Secretary,
War Office,
Imperial Institute,
South Kensington,
London, S.W.7,
and the following number quoted.

WAR OFFICE,
IMPERIAL INSTITUTE,
SOUTH KENSINGTON,
LONDON, S.W.7,

25th November, 1919.

E./ 525774 / 4 (Accounts 4.)

Will you please note that any articles of personal
property now in your possession or subsequently
received by you belonging to the late **No. 203145/
~~6025~~ Private Robert Breakell, 1/4th
Battalion, Loyal North Lancashire
Regiment,**
should be despatched to:—

Mrs. Mary Bradley,

Liverpool Road,

Walmer Bridge,

Longton,

Nr. Preston.

Any medals granted to the deceased that are now
in your possession or that may hereafter reach you
should be disposed of to:—

the same person.

*Despatched
22/8/21*

NO. INFANTRY
RECORD OFFICE

Assistant Financial Secretary

C. Harris

Assistant Financial Secretary.

Request for return of Private BREAKELL's personal effects.

L.H. 2/15/18

Effects—Form 118A.

MEMORANDUM FOR

The Officer in charge of Infantry Records, *202*

Location House

WAR OFFICE,

IMPERIAL INSTITUTE,

SOUTH KENSINGTON,

LONDON, S.W. 7.

Any further communication on this subject should be addressed to:—
The Secretary,
WAR OFFICE,
Imperial Institute,
South Kensington,
LONDON, S.W. 7.
and the following number quoted

RECORDS
OFFICE
15 AUG 1918
SESSIONS PRESENT

E. / 525746 / (Accounts 4)

Will you please note that any articles of personal property now in your possession or subsequently received by you belonging to the late 20145

*No Effects
13-8-18*

should be despatched to:— *London, S. W. 7.*

Any medals granted to the deceased that are now in your possession or that may hereafter reach you should be disposed of to:—

the same person.

363

W. Harris

Assistant Financial Secretary.

*200/10/18
31-7-18*

To be used (a) for recruits enlisting into the Regular Army, and (b) for men of the Territorial Force when they are admitted to Hospital. Army Form B. 178^A to be used for Special Reserve recruits and Special Reservists enlisting into the Regular Army.

MEDICAL HISTORY of

Surname Breakell Christian Name R.

TABLE I.—General Table.

Birthplace { Parish _____ County _____ }
Examined { on 10 day of Sept. 1916, at _____ }
Declared Age 34 years - days.
Trade or Occupation Bricklayer
Height _____ feet _____ inches.
Weight _____ lbs.
Chest Measurement { Girth when fully Expanded _____ inches. Range of Expansion _____ inches. }
Physical Development _____
Vaccination Marks { Arm _____ RIGHT LEFT Number _____ }
When Vaccinated _____
Vision { R.E.—V= _____ L.E.—V= _____ }
(a) Marks indicating congenital peculiarities or previous disease—
(b) Slight defects but not sufficient to cause rejection—
Approved by _____
Rank _____
Medical Officer.

TABLE III.—Boards; Courts of Enquiry, Vaccination, Inoculations, etc.; Examinations for Field or Foreign Service, Extension, Re-engagement, or Prolongation of Service; Issue of Surgical Appliances; Particulars of Dental Treatment, etc.

Table with 2 columns: Date, Brief details, and Signature. Entries include 10/16 Vaccinated, 16/16 1st Inoculation, 17/16 2nd Inoculation.

TABLE IV.—Service Table.

Table with 3 columns: Station or Troopship, Date of arrival or embarkation, Date of departure or disembarkation. Includes rows for Enlisted, Joined on enlistment, Transferred to, and Became non-effective by.

Private BREAKELL's medical record.

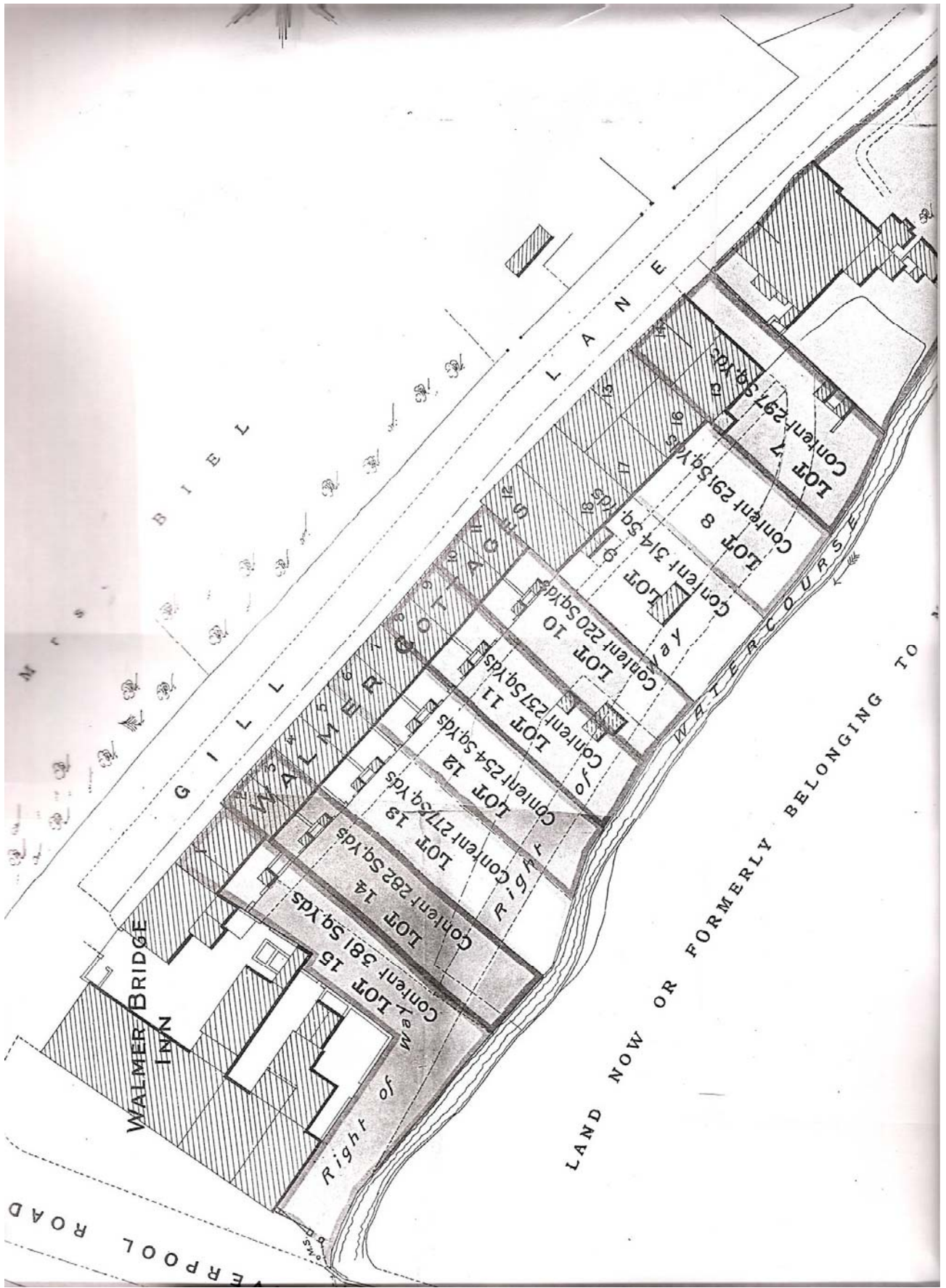

WALMER BRIDGE INN

GILFILLAN LANE

LAND NOW OR FORMERLY BELONGING TO

WATER COURSE

Right of Way

LOT 15
Content 381 Sq. Yds.

LOT 14
Content 282 Sq. Yds.

LOT 13
Content 275 Sq. Yds.

LOT 12
Content 254 Sq. Yds.

LOT 11
Content 237 Sq. Yds.

LOT 10
Content 220 Sq. Yds.

LOT 9
Content 314 Sq. Yds.

LOT 8
Content 291 Sq. Yds.

LOT 7
Content 297 Sq. Yds.

WALMER BRIDGE ROAD

Lancashire **BMD**

Births, Marriages and Deaths on the Internet

In the results below, the reference number will be a link. Clicking on this link will add your choice to a summary list on a new page. From this [summary page](#) you will be able to review all your search results and you will find links to printable application forms which can be used to order the certificate for the index entry. Full details of the charges and the Register Office address can be found on the form.

Lancashire Marriage indexes for the years: 1907

Surname	Forename(s)	Surname	Forename(s)	Church / Register Office	Registers At	Reference
NOBLE	Mary	BREAKELL	Robert	All Saints, Hesketh with Becconsall	Preston	CE10/1/287

Total records matching : 1

No matching records were found for NOBLE in the following years:

1901, 1902, 1903, 1904, 1905, 1906, 1908, 1909, 1910, 1911, 1912, 1913, 1914, 1915

If you haven't found the **NOBLE** that you're looking for, it may be that the indexes for your area of interest have not been transcribed yet. See our [coverage](#) page for more information.

Where the first surname is a web link followed by an asterisk (*), it signifies that there are alternative entries in the database for this reference number. Click on the surname to display the full list of alternatives and an explanation of why this occurs.

Many other counties have their BMD indexes on-line. If you can't find the entry in this area, perhaps you could try a neighbouring area. See the **Local BMD** section of



Information regarding the purchase of certificates can be found in the [Marriages Information](#) page.

Click on the appropriate reference number in the tables above to add your choice to your [summary page](#). From the summary page you will be able to review all your search choices and print off application forms to order copy certificates.

NOTE: Each Region's Register Office has a different address. Please be sure to send your application to the correct office, otherwise your application may be rejected. The appropriate address will be found near the bottom of the application form.

Lancashire **BMD**

Births, Marriages and Deaths on the Internet

In the results below, the reference number will be a link. Clicking on this link will add your choice to a summary list on a new page. From this [summary page](#) you will be able to review all your search results and you will find links to printable application forms which can be used to order the certificate for the index entry. Full details of the charges and the Register Office address can be found on the form.

Lancashire Birth indexes for the years: 1908

Surname	Forename(s)	Sub-District	Registers At	Mother's Maiden Name	Reference
BREAKELL	William	Longton	Preston	NOBLE	LONG/30/78

Lancashire Birth indexes for the years: 1910

Surname	Forename(s)	Sub-District	Registers At	Mother's Maiden Name	Reference
BREAKELL	Elizabeth Esther	Longton	Preston	NOBLE	LONG/31/78

Lancashire Birth indexes for the years: 1914

Surname	Forename(s)	Sub-District	Registers At	Mother's Maiden Name	Reference
BREAKELL	George	Longton	Preston	NOBLE	LONG/33/27

Total records matching : 3.

No matching records were found for BREAKELL in the following years:

1905, 1906, 1907, 1909, 1911, 1912, 1913, 1915

If you haven't found the **BREAKELL** that you're looking for, it may be that the indexes for your area of interest have not been transcribed yet. See our [coverage](#) page for more information.

Many other counties have their BMD indexes on-line. If you can't find the entry in this area, perhaps you could try a neighbouring area. See the **Local BMD** section of



Information regarding the purchase of certificates can be found in the [Birth Information](#) page.

Click on the appropriate reference number in the tables above to add your choice to your [summary page](#). From the summary page you will be able to review all your search choices and print off application forms to order copy certificates.

NOTE: Each Region's Register Office has a different address. Please be sure to send your application to the correct office, otherwise your application may be rejected. The appropriate address will be found near the bottom of the application form.

In the results below, the reference number will be a link. Clicking on this link will add your choice to a summary list on a new page. From this [summary page](#) you will be able to review all your search results and you will find links to printable application forms which can be used to order the certificate for the index entry. Full details of the charges and the Register Office address can be found on the form.

Lancashire Birth indexes for the years: 1912

Surname	Forename(s)	Sub-District	Registers	At Mother's Maiden Name	Reference
BREAKELL	Ethel	Longton	Preston	NOBLET	LONG/32/69

Total records matching : 1.

If you haven't found the **Ethel BREAKELL** that you're looking for, it may be that the indexes for your area of interest have not been transcribed yet. See our [coverage](#) page for more information.

Many other counties have their BMD indexes on-line. If you can't find the entry in this area, perhaps you could try a neighbouring area. See the **Local BMD** section of



Information regarding the purchase of certificates can be found in the [Birth Information](#) page.

Click on the appropriate reference number in the tables above to add your choice to your [summary page](#). From the summary page you will be able to review all your search choices and print off application forms to order copy certificates.

NOTE: Each Region's Register Office has a different address. Please be sure to send your application to the correct office, otherwise your application may be rejected. The appropriate address will be found near the bottom of the application form.

Lancashire **BMD**

Births, Marriages and Deaths on the Internet

In the results below, the reference number will be a link. Clicking on this link will add your choice to a summary list on a new page. From this [summary page](#) you will be able to review all your search results and you will find links to printable application forms which can be used to order the certificate for the index entry. Full details of the charges and the Register Office address can be found on the form.

Lancashire Marriage indexes for the years: 1935

Surname	Forename(s)	Surname	Forename(s)	Church / Register Office	Registers At	Reference
BREAKELL	Elizabeth Esther	DOBSON	Joseph	Penwortham, St Mary	Preston	223/6/154

Total records matching : 1

If you haven't found the **Elizabeth BREAKELL** that you're looking for, it may be that the indexes for your area of interest have not been transcribed yet. See our [coverage](#) page for more information.

Where the first surname is a web link followed by an asterisk (*), it signifies that there are alternative entries in the database for this reference number. Click on the surname to display the full list of alternatives and an explanation of why this occurs.

Many other counties have their BMD indexes on-line. If you can't find the entry in this area, perhaps you could try a neighbouring area. See the **Local BMD** section of



Information regarding the purchase of certificates can be found in the [Marriages Information](#) page.

Click on the appropriate reference number in the tables above to add your choice to your [summary page](#). From the summary page you will be able to review all your search choices and print off application forms to order copy certificates.

NOTE: Each Region's Register Office has a different address. Please be sure to send your application to the correct office, otherwise your application may be rejected. The appropriate address will be found near the bottom of the application form.

In the results below, the reference number will be a link. Clicking on this link will add your choice to a summary list on a new page. From this [summary page](#) you will be able to review all your search results and you will find links to printable application forms which can be used to order the certificate for the index entry. Full details of the charges and the Register Office address can be found on the form.

Lancashire Birth indexes for the years: 1940

Surname	Forename(s)	Sub-District	Registers At	Mother's Maiden Name	Reference
DOBSON	Robert Joseph	Preston South West	Preston	BREAKELL	PSW/10B/44

Lancashire Birth indexes for the years: 1946

Surname	Forename(s)	Sub-District	Registers At	Mother's Maiden Name	Reference
DOBSON	John James	Preston South West	Preston	BREAKELL	PSW/23B/7

Total records matching : 2.

No matching records were found for DOBSON in the following years:

1934, 1935, 1936, 1937, 1938, 1939, 1941, 1942, 1943, 1944, 1945, 1947, 1948, 1949, 1950, 1951, 1952, 1953, 1954, 1955, 1956, 1957, 1958, 1959, 1960

If you haven't found the **DOBSON** that you're looking for, it may be that the indexes for your area of interest have not been transcribed yet. See our [coverage](#) page for more information.

Many other counties have their BMD indexes on-line. If you can't find the entry in this area, perhaps you could try a neighbouring area. See the **Local BMD** section of



Information regarding the purchase of certificates can be found in the [Birth Information](#) page.

Click on the appropriate reference number in the tables above to add your choice to your [summary page](#). From the summary page you will be able to review all your search choices and print off application forms to order copy certificates.

NOTE: Each Region's Register Office has a different address. Please be sure to send your application to the correct office, otherwise your application may be rejected. The appropriate address will be found near the bottom of the application form.

Lancashire **BMD**

Births, Marriages and Deaths on the Internet

In the results below, the reference number will be a link. Clicking on this link will add your choice to a summary list on a new page. From this [summary page](#) you will be able to review all your search results and you will find links to printable application forms which can be used to order the certificate for the index entry. Full details of the charges and the Register Office address can be found on the form.

Lancashire Marriage indexes for the years: 1943

Surname	Forename(s)	Surname	Forename(s)	Church / Register Office	Registers At	Reference
BREAKELL	Ethel	BROOKS	Norman	Preston Register Office or Registrar Attended (ANESS)	Preston	ANESS/8A/229

Total records matching : 1

No matching records were found for Ethel BREAKELL in the following years:

1930, 1931, 1932, 1933, 1934, 1935, 1936, 1937, 1938, 1939, 1940, 1941, 1942, 1944, 1945, 1946, 1947, 1948, 1949, 1950, 1951, 1952, 1953, 1954, 1955, 1956, 1957, 1958, 1959, 1960, 1961, 1962, 1963, 1964

If you haven't found the **Ethel BREAKELL** that you're looking for, it may be that the indexes for your area of interest have not been transcribed yet. See our [coverage](#) page for more information.

Where the first surname is a web link followed by an asterisk (*), it signifies that there are alternative entries in the database for this reference number. Click on the surname to display the full list of alternatives and an explanation of why this occurs.

Many other counties have their BMD indexes on-line. If you can't find the entry in this area, perhaps you could try a neighbouring area. See the **Local BMD** section of



Information regarding the purchase of certificates can be found in the [Marriages Information](#) page.

Click on the appropriate reference number in the tables above to add your choice to your [summary page](#). From the summary page you will be able to review all your search choices and print off application forms to order copy certificates.

NOTE: Each Region's Register Office has a different address. Please be sure to send your application to the correct office, otherwise your application may be rejected. The appropriate address will be found near the bottom of the application form.

William **BREAKELL** and Esther ???
!

George **NOBLE** and Margaret ???
!

Robert **BREAKELL** ... #1 m. ... Mary **NOBLE**
1907

All Saint's, Hesketh with Becconsall
!

!	!	!	!
William	Elizabeth Esther	Ethel	George
!	!	!	!
b. 1908	b. 1910	b. 1912	b. 1914
!	!	!	!
bu. 22 Jun 1944	m. 1935	m. 1943	bu. 8 Oct. 1948
Longton, St. Andrew's	Penwortham, St. Mary's	Norman BROOKS	Longton,
	Joseph DOBSON	Registrar attended	St. Andrew's
	!	!	!
	Robert Joseph DOBSON		m. 1941
	b. 1940		Elsie George
	!		Penwortham
	John James DOBSON		St. Mary's
	1946		!
			!
			!
			!
			!

Extract from the marriage records of All Saint's Church, Hesketh with Becconsall, Hesketh Bank, Lancashire

Lancashire Archives reference PR 3155 / 1 / 6 -

Page 144 No. 287

8 June 1907	Robert BREAKELL	24	Batchelor	Bricklayer	of Longton	William BREAKELL	Oil dealer
	Mary NOBLE	20	Spinster	---	of Hesketh	George NOBLE	Brickworker

(Signed) Robert Breakell
 Mary Noble

(Witnesses) Richard Cookson
 Annie Roskell

(Conducted by) Rev. R. O'Brien

**Extract from the baptismal records of All Saint's Church,
Hesketh with Beconsall, Hesketh Bank, Lancashire
1856 - 1996**

Lancashire Archives reference PR 3155 / 1 / 22

Page 96 No. 766 7 June 1908

William Robert and Mary BREAKELL Longton Bricklayer R. O'Brian

Page 100 No. 794 16 October 1910

Elizabeth Robert and Mary BREAKELL Longton Bricklayer R. O'Brian
Esther

Page 103 No. 818 10 November 1912

Ethel Robert and Mary BREAKELL Longton Bricklayer R. O'Brian

Extract from Barratt's Trade Directory of Preston 1910

Longton Page 596

BREAKELL, Mr. W. Chapel Lane

BREAKELL, Wm., Jnr., driver, Liverpool Road

Administrative County		The undermentioned Houses are situated within the boundaries of the										Page 14	
Civil Parish of LONGTON.		Ecclesiastical Parish of St. Mary (Parish)		County Borough, Municipal Borough, or Urban District of		Rural District of PRESTON.		Parliamentary Borough or Division of BLACKPOOL.		Town or Village or Hamlet of Longton			
No. of Schedules	ROAD, STREET, &c. and No. or NAME of HOUSE	HOUSES			Name and Surname of each Person	RELATION to Head of Family	Age last Birthday of	PROFESSION OR OCCUPATION	Employer, Worker, or Own account	If Working at Home	WHERE BORN	If (1) Deaf and Dumb (2) Blind (3) Lunatic (4) Imbecile, feeble-minded	
		Inhabited	In Church House	In Chapel House									Number of Persons registered in this House
85	Liverpool Rd. (contd)				William J. Lawson	Son	4				Lancs. Haslingford		
					Edith	Daughter	5				do. Longton		
86	do. (contd)				Agnes M. do.	Daughter	3				do. do.		
					George J. Jones	Head	32	Blackman - Domestic			Lancs. Garsdale	✓	
					Mary do.	Wife	35				Worcs. Bewdley	✓	
87	do. (contd)				Carrie do.	Daughter	7				do. Dewsbury	✓	
					Thomas R. Milkin	Head	27	Shallice - Weaver	Employer		Lancs. Longton		
					Lanny do.	Wife	20				do. do.		
					Dorothy do.	Daughter	11				do. do.		
					Betty do.	Daughter	7				do. do.		
					Christopher do.	Son	5				do. do.		
					Geoffrey do.	Son	2				do. do.		
					Agnes Smith	Servant	42	Washer - Domestic	Worker		do. Longton		
					Annie J. Cullerth	Servant	20	Washer - Domestic	do.		do. Preston		
					Mary Jackson	Servant	19	Washer - Domestic	do.		do. Barron		
					Marg B. Miller	Servant	25	Washer - Domestic	do.		do. do.		
					Wm J. Lander	Servant	27	Washer - Domestic	do.		do. do.		
88	do.				William Broadell	Head	68	General Dealer	Employer		Lancs. Lancaster	✓	
					Edith do.	Wife	58				Lancs. Penwortham		
					Mary do.	Daughter	28	Washer - Domestic	Worker		do. do.		
					Robert do.	Son	18	Washer - Domestic	Worker		do. do.		
					William Rockell	Son	9	Washer - Domestic	Worker		do. do.		
89	do.				William Sutton	Head	57	Washer and Draper	Employer		do. Longton		
					Jane do.	Wife	46				do. do.		
					Margaret do.	Daughter	31				do. Thornton		
90	do. (contd)				Francis Lister	Head	46	Physician & Surgeon			do. Longton		
					George Mayne	Servant	24	Washer - Domestic	Worker		do. do.		
					Margie Young	Servant	26	Washer - Domestic	Worker		Lancs. Liverpool		
91	do.				Ullie Mayor	Head	49	Cotton Weaver	Worker		Cumbria. Broughton	✓	
92	do.				John Beresford	Head	34	Washer Cotton Weaver	Worker		Lancs. Longton		
					Mary do.	Wife	32				do. Preston		
7	Total of Schedules of Houses and of Tenements with less than Five Rooms	7		3	Total of Males and of Females...		12	19			do. Much Hoole		

NOTE—Draw your pen through such words of the headings as are inapplicable.

The 1901 census of the Breakell family in Liverpool Road, Longton, close to The Grove and the former corn mill

Administrative County <i>Lancaster</i>		The undermentioned Houses are situate within the boundaries of the										Page 5					
Civil Parish of <i>Tarleton</i>		Ecclesiastical Parish of <i>Tarleton</i>		County Borough, Municipal Borough, or Urban District of		Ward of Municipal Borough or of Urban District of		Rural District <i>West Lancashire</i>		Parliamentary Borough or Division of <i>Chorley</i>		Town or Village or Hamlet of					
Column	1	2	3	4	5	6	7	8	9	10	11	12	13	14	15	16	17
ROAD, STREET &c. and No. or NAME of HOUSE	ROUTES (Unincorporated)	In Road	In Open Place	Not in Road or Open Place	Other	Name and Surname of each Person	RELATION to Head of Family	Condition as to Marriage	Age last Birthday	Male	Female	PROFESSION OR OCCUPATION	Employer, Worker, or Own account	If Working at Home	WHERE BORN	(1) Deaf and Dumb (2) Blind (3) Lame (4) Insane, feeble- in fact	
27	Hesketh Lane	1				John Smith	Head	34	21			1	1	1	1	1	1
						Ann Smith	Wife	34	19			1	1	1	1	1	1
						John H. Do	Son	3	3.10.0			1	1	1	1	1	1
28	Do	1				John Pickney	Head	Wid	55			1	1	1	1	1	1
						John Do	Son	5	17			1	1	1	1	1	1
						Sarah C. Latham	Daughter	34	29			1	1	1	1	1	1
						John A. Do	Son in Law	34	29			1	1	1	1	1	1
						Mary C. Do	Grand Daughter	5	9.10.0			1	1	1	1	1	1
						Margaret J. Mayor	Serv	5	23			1	1	1	1	1	1
29	Do	1				Thomas Asodekian	Head	Wid	68			1	1	1	1	1	1
						Grace Martin	Serv	Wid	50			1	1	1	1	1	1
30	Do	1				William Pyle	Head	34	15			1	1	1	1	1	1
						Sarah Do	Wife	34	35			1	1	1	1	1	1
31	Do	1				William Cookson	Head	34	24			1	1	1	1	1	1
						Mary Do	Wife	34	27			1	1	1	1	1	1
33	Do	1				William C. Bishop	Head	34	37			1	1	1	1	1	1
						Elizabeth Do	Wife	34	33			1	1	1	1	1	1
						William J. Do	Son	5	9			1	1	1	1	1	1
						Margaret Do	Daughter	5	7			1	1	1	1	1	1
34	Do	1				George Noble	Head	34	37			1	1	1	1	1	1
						Margaret Do	Wife	34	43			1	1	1	1	1	1
						James Cookson	Son	5	21			1	1	1	1	1	1
						Mary Noble	Daughter	5	13			1	1	1	1	1	1
						Margaret Do	Daughter	5	11			1	1	1	1	1	1
						Richard Do	Son	5	10			1	1	1	1	1	1
						Elizabeth Do	Daughter	5	9			1	1	1	1	1	1
	Total of Schedules of Houses and of Trans- actions with less than Five Entries	6	1	1	1		Total of Males and of Females..		13	13							

NOTE—Draw your pen through such words of the headings as are inapplicable.

The 1901 census of the Noble family residing in Hesketh Lane, Tarleton.
It would appear that both adults have brought children with them from previous relationships.

In the results below, the reference number will be a link. Clicking on this link will add your choice to a summary list on a new page. From this [summary page](#) you will be able to review all your search results and you will find links to printable application forms which can be used to order the certificate for the index entry. Full details of the charges and the Register Office address can be found on the form.

Lancashire Marriage indexes for the years: 1897

Surname	Forename(s)	Surname	Forename(s)	Church / Register Office	Registers At	Reference
COOKSON	Margaret	NOBLE	George	Ormskirk Register Office or Registrar Attended	Preston	RM/37/88

Total records matching : 1

If you haven't found the **Margaret COOKSON** that you're looking for, it may be that the indexes for your area of interest have not been transcribed yet. See our [coverage](#) page for more information.

Where the first surname is a web link followed by an asterisk (*), it signifies that there are alternative entries in the database for this reference number. Click on the surname to display the full list of alternatives and an explanation of why this occurs.

Many other counties have their BMD indexes on-line. If you can't find the entry in this area, perhaps you could try a neighbouring area. See the **Local BMD** section of



Information regarding the purchase of certificates can be found in the [Marriages Information](#) page.

Click on the appropriate reference number in the tables above to add your choice to your [summary page](#). From the summary page you will be able to review all your search choices and print off application forms to order copy certificates.

NOTE: Each Region's Register Office has a different address. Please be sure to send your application to the correct office, otherwise your application may be rejected. The appropriate address will be found near the bottom of the application form.

CENSUS OF ENGLAND AND WALES, 1911.

Number of Schedule 256
(To be filled up by the Enumerator after collection.)

Before writing on this Schedule please read the Examples and the Instructions given on the other side of the paper, as well as the headings of the Columns. The entries should be written in Ink.

The contents of the Schedule will be treated as confidential. Strict care will be taken that no information is disclosed with regard to individual persons. The returns are not to be used for proof of age, as in connection with Old Age Pensions, or for any other purpose than the preparation of Statistical Tables.

NAME AND SURNAME	RELATIONSHIP to Head of Family.	AGE (date Birthday) and SEX.		PARTICULARS as to MARRIAGE.					PROFESSION or OCCUPATION of Persons aged ten years and upwards.				BIRTHPLACE of every person.	NATIONALITY of every Person born in a Foreign Country.	INFIRMITY.
		For Infants under one year state the age in months as "one month," etc.	Ages of Males.	Ages of Females.	States, for each Married Woman entered on this Schedule, the number of:—					Personal Occupation.	Industry or Service with which worker is connected.	Whether Employer, Worker, or Working on Own Account.			
of every Person, whether Member of Family, Visitor, Boarder, or Servant, who (1) passed the night of Sunday, April 2nd, 1911, in this dwelling and was alive at midnight, or (2) arrived in this dwelling on the morning of Monday, April 3rd, not having been enumerated elsewhere. No one else must be included. (For order of entering names see Examples on back of Schedule.)	State whether "Head," or "Wife," "Son," "Daughter," or other Relative, "Visitor," "Boarder," or "Servant."	Write "Single," "Married," "Widower," or "Widow," opposite the names of all persons aged 15 years and upwards.	Completed years the present Marriage has lasted. If less than one year write "under one."	Children born alive to present Marriage. (If no children born alive write "None" in Column 7.)	Total Children Born Alive.	Children still Living.	Children who have Died.	The reply should show the precise branch of Profession, Trade, Manufacture, &c. If engaged in any Trade or Manufacture, the particular kind of work done, and the Article made or Material worked or dealt in should be clearly indicated. (See Instructions 1 to 8 and Examples on back of Schedule.)	This question should generally be answered by stating the business carried on by the employer. If this is clearly shown in Col. 10 the question need not be answered here. No entry needed for Domestic Servants in private employment. If employed by a public body (Government, Municipality, etc.) state what body. (See Instruction 9 and Examples on back of Schedule.)	Write opposite the name of each person engaged in any Trade or Industry, (1) "Employer," (that is employing persons other than Domestic servants), or (2) "Worker" (that is working for an employer), or (3) "Own Account" (that is neither employing others nor working for a trade employer).	Write the words "At Home" opposite the name of each person carrying on Trade or Industry at home.	(1) If born in the United Kingdom, write the name of the County, and Town or Parish. (2) If born in any other part of the British Empire, write the name of the Dependency, Colony, etc., and of the Province or State. (3) If born in a Foreign Country, write the name of the Country. (4) If born at sea, write "At Sea."	State whether:— (1) "British subject," giving Year of naturalisation. (2) "Totally Blind," (3) "Lunatic," (4) "Insane," or "Feeble-minded," state the infirmity opposite that person's name, and the age at which he or she became afflicted.		
1 Robert Breakell	Head	28		Married				Bricklayer 220	Building Trade	Worker		Breston	Essex 062		
2 Mary Breakell	Wife	24		Married	4	2	0					Heshth Bank	Essex		
3 William Breakell	Son	3										Longton	Essex		
4 Elizabeth Esther Breakell	Daughter	1 month										Longton	Essex		
5 Maggie Noble	Boarder	21		Single				Winder at Mill (Cotton)		Worker		Heshth Bank	Essex		
6															
7															
8															
9															
10															
11															
12															
13															
14															
15															

(To be filled up by the Enumerator.)

I certify that—
 (1) All the ages on this Schedule are entered in the proper sex column.
 (2) I have counted the males and females in Columns 3 and 4 separately, and have compared their sum with the total number of persons.
 (3) After making the necessary enquiries I have completed all entries on the Schedule which appeared to be defective, and have corrected such as appeared to be erroneous.

Initials of Enumerator: W.

Total.		
Males	Females	Persons
2	3	5

(To be filled up by, or on behalf of, the Head of Family or other person in occupation, or in charge, of this dwelling.)

Write below the Number of Rooms in this Dwelling (House, Tenement, or Apartment). Count the kitchen as a room but do not count scullery, landing, lobby, closet, bathroom, nor warehouse, office, shop.

3 rooms

I declare that this Schedule is correctly filled up to the best of my knowledge and belief.

Signature: Robert Breakell

Postal Address: Chapel Lane Longton

1911 Census of the Breakell family, with their first two children, residing in Chapel Lane, Longton, with Mary's sister, Margaret, residing with them.

ALPHABETICAL NAMES INDEX OF THE GRAVE REGISTERS OF
LONGTON ST. ANDREW'S PARISH CHURCH

BREAKELL, George	08. Oct. 1948	34	34	Shirley Estate	NA34
BREAKELL, Hannah	08. Jan. 1965	325	77	Elmslie Terrace, Liverpool Road, Longton	NG83 or H325
BREAKELL, William	22. Jun. 1944	34	35	8 Anchor Drive, Hutton	NA34
BREAKELL, William	01. Apr. 1963	325	87	Elmslie Terrace, Liverpool Road, Longton	NG83 or NH325
<u>Name</u>	<u>Burial Date</u>	<u>Page No</u>	<u>Age</u>	<u>Other Details</u>	<u>Grave No</u>

It has not been established yet if Hannah (1965) and William (1963) are related to George (1948) and William (1944).

THE REGISTER WAS COMMENCED ON 14TH AUGUST 1939 AND CONCLUDED ON 27TH MAY, 1987.

Lancashire **BMD**

Births, Marriages and Deaths on the Internet

In the results below, the reference number will be a link. Clicking on this link will add your choice to a summary list on a new page. From this [summary page](#) you will be able to review all your search results and you will find links to printable application forms which can be used to order the certificate for the index entry. Full details of the charges and the Register Office address can be found on the form.

Lancashire Marriage indexes for the years: 1918

Surname	Forename(s)	Surname	Forename(s)	Church / Register Office	Registers At	Reference
BREAKELL	Mary	BRADLEY	George	Preston Register Office or Registrar Attended	Preston	Preston 155/174

Total records matching : 1

If you haven't found the **Mary BREAKELL** that you're looking for, it may be that the indexes for your area of interest have not been transcribed yet. See our [coverage](#) page for more information.

Where the first surname is a web link followed by an asterisk (*), it signifies that there are alternative entries in the database for this reference number. Click on the surname to display the full list of alternatives and an explanation of why this occurs.

Many other counties have their BMD indexes on-line. If you can't find the entry in this area, perhaps you could try a neighbouring area. See the **Local BMD** section of



Information regarding the purchase of certificates can be found in the [Marriages Information](#) page. Click on the appropriate reference number in the tables above to add your choice to your [summary page](#). From the summary page you will be able to review all your search choices and print off application forms to order copy certificates.

NOTE: Each Region's Register Office has a different address. Please be sure to send your application to the correct office, otherwise your application may be rejected. The appropriate address will be found near the bottom of the application form.

© 2014

Private BREAKELL's wife later re-married to George BRADLEY...

In the results below, the reference number will be a link. Clicking on this link will add your choice to a summary list on a new page. From this [summary page](#) you will be able to review all your search results and you will find links to printable application forms which can be used to order the certificate for the index entry. Full details of the charges and the Register Office address can be found on the form.

Lancashire Birth indexes for the years: 1923

Surname	Forename(s)	Sub-District	Registers At	Mother's Maiden Name	Reference
BRADLEY	Doris Margaret	Longton	Preston	BREAKELL	LONG/36/48

Total records matching : 1.

No matching records were found for BRADLEY in the following years:

1916, 1917, 1918, 1919, 1920, 1921, 1922, 1924, 1925, 1926, 1927, 1928, 1929, 1930, 1931, 1932, 1933, 1934, 1935, 1936, 1937, 1938, 1939, 1940

If you haven't found the **BRADLEY** that you're looking for, it may be that the indexes for your area of interest have not been transcribed yet. See our [coverage](#) page for more information.

Many other counties have their BMD indexes on-line. If you can't find the entry in this area, perhaps you could try a neighbouring area. See the **Local BMD** section of



Information regarding the purchase of certificates can be found in the [Birth Information](#) page. Click on the appropriate reference number in the tables above to add your choice to your [summary page](#). From the summary page you will be able to review all your search choices and print off application forms to order copy certificates.

NOTE: Each Region's Register Office has a different address. Please be sure to send your application to the correct office, otherwise your application may be rejected. The appropriate address will be found near the bottom of the application form.

© 2014

...and subsequently had a daughter Doris Margaret

ALPHABETICAL NAMES INDEX OF THE GRAVE REGISTERS OF

LONGTON ST. ANDREW'S PARISH CHURCH

<u>Name</u>	<u>Burial Date</u>	<u>Page No</u>	<u>Age</u>	<u>Other Details</u>	<u>Grave No</u>
BRADLEY, Anna Rose	???	251	??		NGE184
BRADLEY, George	19. Sep. 1959	277	69	Laxey Villa, Chapel Lane, also 6 East Sq	NG277
BRADLEY, John David	02. Oct. 1981	147	3	11 West View, Longton	NGC81
BRADLEY, Mary	20. Aug. 1941	34	53	8 Anchor Drive, Hutton, no curb fees aid	NA34
BRADLEY, Theresa	22. Apr. 1897	263	2	Gile's Row, Walmer Bridge, Longton	263

THIS INDEX HAS BEEN COMPILED FROM THE TWO GRAVE REGISTERS HELD BY THE CHURCH.

THE FIRST REGISTER WAS COMMENCED ON 19TH JULY 1895 WHEN GEORGE CHECKETTS WAS INTERRED AND CONTINUES IN USE AS RELATIVES OF THOSE ALREADY INTERRED PASS AWAY. THESE ENTRIES ARE SHOWN IN THE INDEX UNDER BLACK TYPE.

THE SECOND REGISTER WAS COMMENCED ON 14TH AUGUST 1939 WITH THE ENTRY FOR DEREK TAYLOR, AND THESE ENTRIES ARE SHOWN IN MAGENTA TYPE. THE REGISTERS CONCLUDE WITH JOHN BARKER ON 27TH MAY, 1987.

OTHER POSSIBLY LATER NAMES HAVE BEEN ENTERED, BUT NO DATES ARE WRITTEN ALONGSIDE THE ENTRY.

WHERE DETAILS ARE UNKNOWN OR CANNOT BE DECIPHERED THE 'OPPOSITE' COLOUR IS USED TO HIGHLIGHT.

In the results below, the reference number will be a link. Clicking on this link will add your choice to a summary list on a new page. From this [summary page](#) you will be able to review all your search results and you will find links to printable application forms which can be used to order the certificate for the index entry. Full details of the charges and the Register Office address can be found on the form.

Lancashire Marriage indexes for the years: 1946

Surname	Forename(s)	Surname	Forename(s)	Church / Register Office	Registers At	Reference
BRADLEY	Doris Margaret	HARRISON	Gerald Norman	Preston Register Office or Registrar Attended	Preston	ANESS/12A/56

Total records matching : 1

No matching records were found for Doris margaret BRADLEY in the following years:

1941, 1942, 1943, 1944, 1945, 1947, 1948, 1949, 1950, 1951, 1952, 1953, 1954, 1955, 1956, 1957, 1958, 1959, 1960, 1961, 1962, 1963, 1964, 1965, 1966, 1967, 1968, 1969, 1970, 1971, 1972, 1973, 1974, 1975

If you haven't found the **Doris margaret BRADLEY** that you're looking for, it may be that the indexes for your area of interest have not been transcribed yet. See our [coverage](#) page for more information.

Where the first surname is a web link followed by an asterisk (*), it signifies that there are alternative entries in the database for this reference number. Click on the surname to display the full list of alternatives and an explanation of why this occurs.

Many other counties have their BMD indexes on-line. If you can't find the entry in this area, perhaps you could try a neighbouring area. See the **Local BMD** section of



Information regarding the purchase of certificates can be found in the [Marriages Information](#) page. Click on the appropriate reference number in the tables above to add your choice to your [summary page](#). From the summary page you will be able to review all your search choices and print off application forms to order copy certificates.

NOTE: Each Region's Register Office has a different address. Please be sure to send your application to the correct office, otherwise your application may be rejected. The appropriate address will be found near the bottom of the application form.

