



**H**E whom this scroll commemorates was numbered among those who, at the call of King and Country, left all that was dear to them, endured hardness, faced danger, and finally passed out of the sight of men by the path of duty and self-sacrifice, giving up their own lives that others might live in freedom. Let those who come after see to it that his name be not forgotten.

123696, GUNNER, Richard BRIGGS

Royal Garrison Artillery

Killed in action, France & Flanders, 07/08/17

Born: Layton, Lancs, Enlisted: Preston, Residence: Longton, Lancs

**In Memory of  
Gunner RICHARD BRIGGS**

**123696, 297th Siege Bty.,  
Royal Garrison Artillery**

**who died age 19 on 07 August 1917**

**Son of Elizabeth Ellen Forshaw,  
of 21, Walmer Cottages, Gill Lane, Longton, Preston.**

**Remembered with honour  
DICKEBUSCH NEW MILITARY CEMETERY  
EXTENSION**



**Commemorated in perpetuity by  
the Commonwealth War Graves Commission**

**Name:** BRIGGS, RICHARD

**Initials:** R

**Nationality:** United Kingdom

**Rank:** Gunner

**Regiment/Service:** Royal Garrison Artillery

**Unit Text:** 297th Siege Bty.

**Age:** 19

**Date of Death:** 07/08/1917

**Service No:** 123696

**Additional information:** Son of Elizabeth Ellen Forshaw, of 21, Walmer Cottages, Gill Lane, Longton, Preston.

**Casualty Type:** Commonwealth War Dead

**Grave/Memorial Reference:** II. G. 11.

**Cemetery:** [DICKEBUSCH NEW MILITARY CEMETERY EXTENSION](#)

**Cemetery:** DICKEBUSCH NEW MILITARY CEMETERY EXTENSION

**Country:** Belgium

**Locality:** unspecified

**Visiting Information:** Wheelchair access possible via main entrance. For further information regarding wheelchair access, please contact our Enquiries Section on telephone number: 01628 507200.

**Location Information:** From Ieper town centre the Dikkebusseweg (N375), is reached via Elverdingsestraat, straight over a roundabout onto J.Capronstraat (for 30 metres), then left along M.Fochlaan. Immediately after the train station, the first right hand turning is the Dikkebusseweg. On reaching the village of Dikkebus, the cemetery is located on the Kerkstraat, which is a small street turning left off the Dikkebusseweg. 200 metres along this street, and just beyond the village church, lies the cemetery.

**Historical Information:** The New Military Cemetery was begun in February 1915 and was used until May 1917 by fighting units and field ambulances, with a few further burials taking place in March and April 1918. The Extension was used from May 1917 to January 1918. The New Military Cemetery contains 624 First World War burials, the Extension 547. The site was designed by Sir Edwin Lutyens.

**No. of Identified Casualties:** 542

# Cemetery Plans

## DICKEBUSCH NEW MILITARY CEMETERY EXTENSION

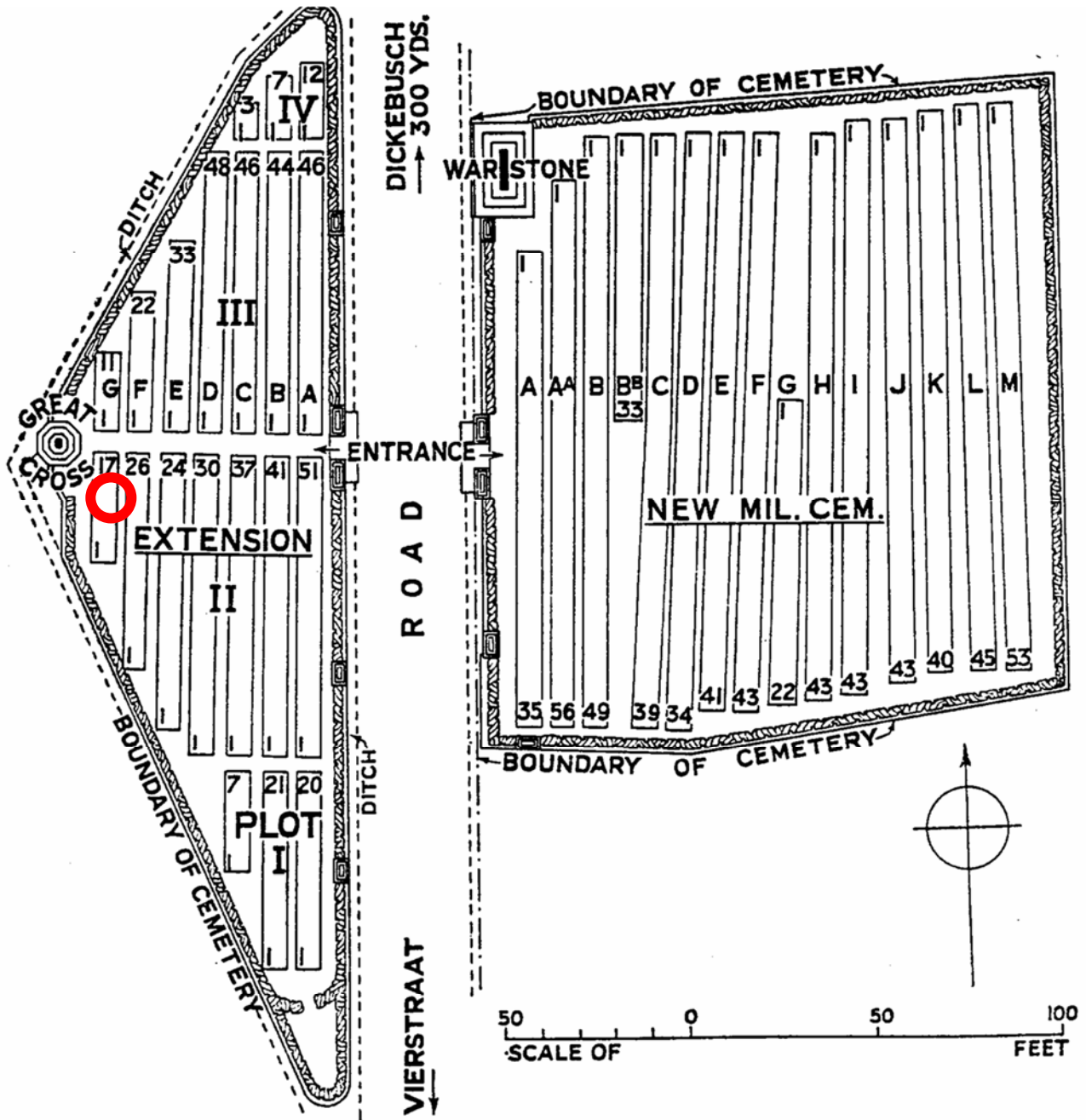

DICKEBUSCH NEW MILITARY CEMETERY AND EXTENSION.

Private Brigg's grave highlighted at II. G. 11.

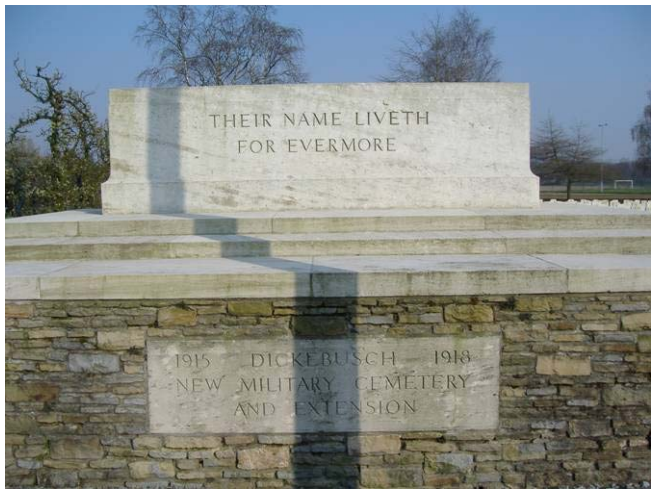

**Richard BRIGG's grave at  
Dickebusch New Military Cemetery  
Extension, near Ieper, Belgium,  
no. II. G. 11**

| Name.                          | Corps.          | Rank. | Regt. No.                   |
|--------------------------------|-----------------|-------|-----------------------------|
| BRIGGS                         | P. S. A.        | Gnr.  | 123696                      |
|                                |                 |       |                             |
|                                |                 |       |                             |
|                                |                 |       |                             |
| Richard.                       |                 |       |                             |
| Medal.                         | Roll.           | Page. | Remarks.                    |
| VICTORY                        | P. S. A. / 170B | 7054  | } Roll (1743-KR) - 8101 ad. |
| BRITISH                        | do              | do    |                             |
| STAR                           |                 |       |                             |
|                                |                 |       |                             |
|                                |                 |       |                             |
| Theatre of War first served in |                 |       |                             |
| Date of entry therein          |                 |       |                             |
|                                |                 |       | 8101 ad.                    |
|                                |                 |       | hw/5/15584                  |
|                                |                 |       | E/466199/2                  |
|                                |                 |       | K/1380                      |

Off. records forwarded by re. disposal of medals 24.10.71  
 Correspondence.

Address.

The Medal Record Card of Gunner Richard BRIGGS

## Medals awarded to Gunner 123696 Richard BRIGGS



### **The Allied Victory Medal**

Also known as 'Wilfred'

It was decided that each of the allies should each issue their own bronze victory medal with a similar design, similar equivalent wording and identical ribbon.

The British medal was designed by W. McMillan. The front depicts a winged classical figure representing victory.

Approximately 5.7 million victory medals were issued. Interestingly, eligibility for this medal was more restrictive and not everyone who received the British War Medal ('Squeak') also received the Victory Medal ('Wilfred'). However, in general, all recipients of 'Wilfred' also received 'Squeak' and all recipients of 'Pip' also received both 'Squeak' and 'Wilfred'.

The recipient's service number, rank, name and unit was impressed on the rim.



### **The British War Medal 1914 – 1918**

Established on 26<sup>th</sup> July 1919.

Also known as 'Squeak'.

The silver or bronze medal was awarded to officers and men of the British and Imperial Forces who either entered a theatre of war or entered service overseas between 5<sup>th</sup> August 1914 and 11<sup>th</sup> November 1918 inclusive. This was later extended to services in Russia, Siberia and some other areas in 1919 and 1920.

Approximately 6.5 million British War Medals were issued.

Approximately 6.4 million of these were the silver versions of this medal.

Around 110,000 of a bronze version were issued mainly to Chinese, Maltese and Indian Labour Corps. The front (obv or obverse) of the medal depicts the head of George V.

The recipient's service number, rank, name and unit was impressed on the rim.



It is our sad duty to chronicle the death of yet another Longton man in France. Gunner R. Briggs of Walmer Bridge Cottages, joined the Royal Field Artillery in October, 1916, and went to France on 19<sup>th</sup> July, 1917, and was killed on August 7<sup>th</sup>. He was only 19 years of age and before joining up he worked for Mr. D. Moss. We offer our deepest sympathy to his parents.

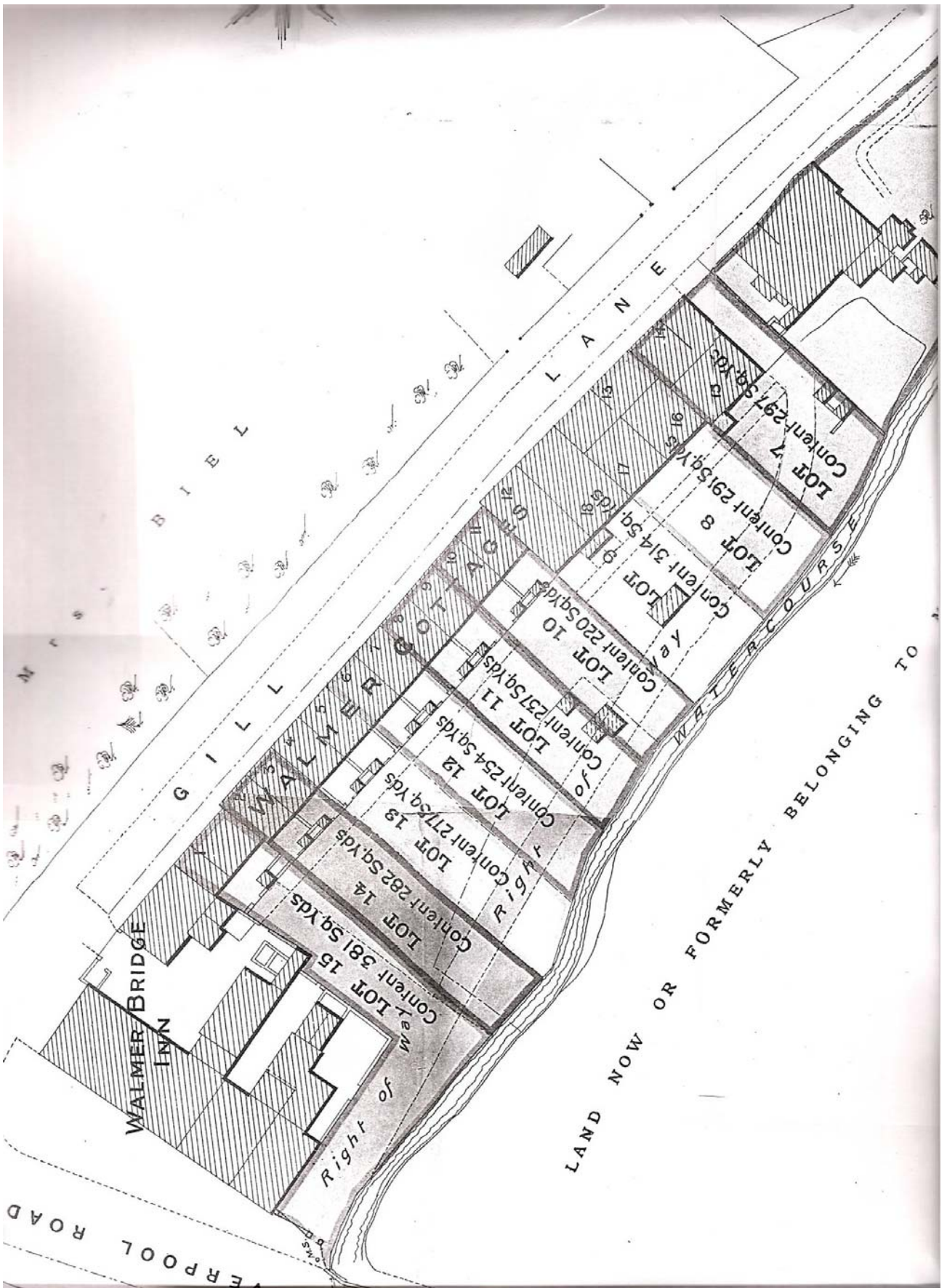

WALMER BRIDGE INN

GILL LANE

WATER COURSE

LAND NOW OR FORMERLY BELONGING TO

Right of Way

LOT 15  
Content 381 sq. yds.

LOT 14  
Content 282 sq. yds.

LOT 13  
Content 277 sq. yds.

LOT 12  
Content 254 sq. yds.

LOT 11  
Content 237 sq. yds.

LOT 10  
Content 220 sq. yds.

LOT 9  
Content 314 sq. yds.

LOT 8  
Content 293 sq. yds.

LOT 7  
Content 297 sq. yds.

WALMER BRIDGE INN



The Town of Preston,  
in the County of  
-- Lancashire --

Marriage: 20 Aug 1849 St John, Preston, Lancashire, England  
Henry Dawson Briggs - 27, Railway Porter, Bachelor, Mount Street  
Jane Mee - (X), 29, Servant, Spinster, Fishergate  
Groom's Father: late Edward Briggs, Surgeon  
Bride's Father: James Mee, Farmer  
Witness: Edward Briggs; Mary Hodgson, (X)  
Married by License by: John Kitton, Offng. Minister  
Register: Marriages 1849 - 1850, Page 74, Entry 148  
Source: LDS Film 93994

In the results below, the reference number will be a link. Clicking on this link will add your choice to a summary list on a new page. From this [summary page](#) you will be able to review all your search results and you will find links to printable application forms which can be used to order the certificate for the index entry. Full details of the charges and the Register Office address can be found on the form.

## Lancashire Birth indexes for the years: 1877

| Surname | Forename(s)     | Sub-District | Registers<br>At | Mother's<br>Maiden<br>Name | Reference                  |
|---------|-----------------|--------------|-----------------|----------------------------|----------------------------|
| BRIGGS  | Elizabeth Ellen | Longton      | Preston         | BRIGGS                     | <a href="#">LONG/18/18</a> |

Total records matching : 1.

**No matching records were found for Elizabeth e BRIGGS in the following years:** 1871, 1872, 1873, 1874, 1875, 1876, 1878, 1879, 1880

If you haven't found the **Elizabeth e BRIGGS** that you're looking for, it may be that the indexes for your area of interest have not been transcribed yet. See our [coverage page](#) for more information.

**Many other** counties have their BMD indexes on-line. If you can't find the entry in this area, perhaps you could try a neighbouring area. See the **Local BMD** section of Information regarding the purchase of certificates can be found in the [Birth Information](#) page.



Click on the appropriate reference number in the tables above to add your choice to your [summary page](#). From the summary page you will be able to review all your search choices and print off application forms to order copy certificates.

**NOTE:** Each Region's Register Office has a different address. Please be sure to send your application to the correct office, otherwise your application may be rejected.

The appropriate address will be found near the bottom of the application form.



The Parish of Hoole  
in the County of  
-- Lancashire --

Baptism: 12 Aug 1877 St Michael, Hoole, Lancashire, England  
Elizabeth Ellen Briggs - Dau of Mary Alice Briggs

Abode: Longton

Notes: Single Woman

Baptised by: R Brickel Rector

Register: Baptisms 1836 - 1900, Page 145, Entry 1158

Source: LDS Film 1471151

In the results below, the reference number will be a link. Clicking on this link will add your choice to a summary list on a new page. From this [summary page](#) you will be able to review all your search results and you will find links to printable application forms which can be used to order the certificate for the index entry. Full details of the charges and the Register Office address can be found on the form.

## Lancashire Marriage indexes for the years: 1880

| Surname | Forename(s) | Surname | Forename(s) | Church / Register Office | Registers At | Reference                 |
|---------|-------------|---------|-------------|--------------------------|--------------|---------------------------|
| BRIGGS  | Mary Alice  | MOSS    | James       | Penwortham, St Mary      | Preston      | <a href="#">223/2/403</a> |

Total records matching : 1

If you haven't found the **Mary Alice BRIGGS** that you're looking for, it may be that the indexes for your area of interest have not been transcribed yet. See our [coverage](#) page for more information.

Where the first surname is a web link followed by an asterisk (\*), it signifies that there are alternative entries in the database for this reference number. Click on the surname to display the full list of alternatives and an explanation of why this occurs.

**Many other** counties have their BMD indexes on-line. If you can't find the entry in this area, perhaps you could try a neighbouring area. See the **Local BMD** section of



Information regarding the purchase of certificates can be found in the [Marriages Information](#) page.

Click on the appropriate reference number in the tables above to add your choice to your [summary page](#). From the summary page you will be able to review all your search choices and print off application forms to order copy certificates.

**NOTE:** Each Region's Register Office has a different address. Please be sure to send your application to the correct office, otherwise your application may be rejected.

The appropriate address will be found near the bottom of the application form.



The Parish of Penwortham  
in the County of  
-- Lancashire --

Marriage: 22 Apr 1880 St Mary, Penwortham, Lancashire, England

James Moss - 23, Weaver, Bachelor, Longton

Mary Alice Briggs - 23, Spinster, Longton

Groom's Father: Thomas Rawcliffe, Joiner

Bride's Father: Henry Briggs, Brewer's Labourer

Witness: Richard Briggs; Elizabeth Ann Briggs

Married by banns by: James B. Phillips

Notes: [Groom's Surname differs to his Father's Surname]

Register: Marriages 1857 - 1885, Page 202, Entry 403

Source: LDS Film 1526058

The undermentioned Houses are situate within the Boundaries of the

| City or Municipal Borough of | Municipal Ward of                           | Parliamentary Borough of | Town or Village or Hamlet of | Urban Sanitary District of      | Rural Sanitary District of | Eccelesiastical Parish or District of |                      |                                 |                    |  |  |
|------------------------------|---|--------------------------|------------------------------|---------------------------------|----------------------------|---------------------------------------|----------------------|---------------------------------|--------------------|--|--|
| Longton                      |   |                          |                              |                                 | Preston                    | Pewortham                             |                      |                                 |                    |  |  |
| No. of Schedule              | ROAD, STREET, &c., and No. or NAME of HOUSE | HOUSES                   |                              | NAME and Surname of each Person | RELATION to Head of Family | CON-DITION as to Marriage             | AGE last Birthday of | Rank, Profession, or OCCUPATION | WHERE BORN         | II<br>(1) Deaf and Dumb<br>(2) Blind<br>(3) Imbecile or Idiot<br>(4) Lunatic |  |
|                              |   | Ex-cluded (A)            | Un-in-cluded (B)             |                                 |                            |                                       |                      |                                 |                    |  |  |
| 77                           | Marsh Lane                                  | 1                        |                              | Robert Johnson                  | Head                       | Mar                                   | 68                   | Farmer 18 acres                 | Lancaster Preston  |  |  |
|                              |   |                          |                              | Ellen do                        | Wife                       | Mar                                   | 68                   | Farmer's wife                   | do Hulton          |  |  |
| 78                           | do  | 1                        |                              | Henry Barker                    | Head                       | Mar                                   | 57                   | Ag. Lab.                        | do Longton         |  |  |
|                              |   |                          |                              | Ann do                          | Wife                       | Mar                                   | 57                   |                                 | do Pewortham       |  |  |
|                              |   |                          |                              | Thurston do                     | Son                        |                                       | 13                   | Scholar                         | do Longton         |  |  |
|                              |   |                          |                              | Samy do                         | Daughter                   |                                       | 11                   | do                              | do do              |  |  |
|                              |   |                          |                              | John do                         | Son                        |                                       | 8                    | do                              | do do              |  |  |
|                              |   |                          |                              | Mary do                         | Daughter                   |                                       | 5                    | do                              | do do              |  |  |
|                              |   |                          |                              | Alice do                        | Daughter                   |                                       | 3                    | do                              | do do              |  |  |
| 79                           | do  | 1                        |                              | Thomas Beadsworth               | Head                       | Mar                                   | 73                   | Farmer 73 acres                 | do do              |  |  |
|                              |   |                          |                              | Mary do                         | Sister                     | Mar                                   | 68                   |                                 | do do              |  |  |
| 80                           | do  | 1                        |                              | John Culliffe                   | Head                       | Mar                                   | 71                   | General Lab.                    | do do              |  |  |
|                              |   |                          |                              | Elizabeth Burrough              | Serv.                      | Mar                                   | 40                   | formerly Cotton Weaver          | do do              |  |  |
| 81                           | do  | 1                        |                              | Richard Thompson                | Head                       | Mar                                   | 32                   | Cooper                          | do Ulverston       |  |  |
|                              |   |                          |                              | Mary do                         | Wife                       | Mar                                   | 35                   | Cooper's wife                   | Cumberland Ulldale |  |  |
|                              |   |                          |                              | Harriet do                      | Daughter                   |                                       | 9                    | Scholar                         | Lancaster Barrow   |  |  |
|                              |   |                          |                              | Mary E. do                      | Daughter                   |                                       | 6                    | do                              | do do              |  |  |
|                              |   |                          |                              | William A. do                   | Son                        |                                       | 14                   | do                              | do Ulverston       |  |  |
|                              |   |                          |                              | Sarah E. do                     | Daughter                   |                                       | 1                    | do                              | do Longton         |  |  |
| 82                           | do  | 1                        |                              | Margery Harrison                | Head                       | Mar                                   | 66                   | grocer                          | do do              |  |  |
|                              |   |                          |                              | William do                      | Son                        | Mar                                   | 29                   | Farm Labourer                   | do do              |  |  |
| 83                           | do  | 1                        |                              | James Moss                      | Head                       | Mar                                   | 23                   | Cotton weaver                   | do do              |  |  |
|                              |   |                          |                              | Mary A. do                      | Wife                       | Mar                                   | 23                   | do                              | do Hoole           |  |  |
|                              |   |                          |                              | Henry B. do                     | Son                        |                                       | 7 mo                 |                                 | do Longton         |  |  |
| Total of Houses...           |   | 4                        |                              | Total of Males and Females...   |                            |                                       | 11                   | 13                              |                    |  |  |

Note.—Draw the pen through such of the words of the headings as are inappropriate.

|                      |   |   |   |   |   |             |
|----------------------|---|---|---|---|---|-------------|
| PUBLIC RECORD OFFICE |   |   |   |   |   | Reference:— |
| 1                    | 2 | 3 | 4 | 5 | 6 |             |
| 1                    |   |   |   |   |   | 2           |
| RG 11 / 4223         |   |   |   |   |   |             |

COPYRIGHT PHOTOGRAPH - NOT TO BE REPRODUCED PHOTOGRAPHICALLY WITHOUT PERMISSION OF THE PUBLIC RECORD OFFICE, LONDON

The 1881 Census with Mary Alice (Briggs) Forshaw with her new family in Marsh Lane, Longton  
RG 11 / 4223 / F. 65 / P. 16 / Sch. 83



The undermentioned Houses are situate within the Boundaries of the

11 [Page 15]

| Municipal Borough of |   | Municipal Ward of |                    | Parliamentary Borough of        |                            | Town or Village or Hamlet of |                      | Urban Sanitary District of      |                               | Rural Sanitary District of |           | Ecclesiastical Parish or District of |             |
|----------------------|---|-------------------|--------------------|---------------------------------|----------------------------|------------------------------|----------------------|---------------------------------|-------------------------------|----------------------------|-----------|--------------------------------------|-------------|
| Longton              |   |                   |                    |                                 |                            | Longton                      |                      |                                 |                               | Preston                    |           | Penwortham                           |             |
| No. of Schedule      | ROAD, STREET, &c., and No. or NAME of HOUSE | HOUSES            |                    | NAME and Surname of each Person | RELATION to Head of Family | CON-DITION as to Marriage    | AGE last Birthday of | Rank, Profession, or OCCUPATION | WHERE BORN                    | II                         |           |                                      |             |
|                      |   | In-habit-ed (1)   | Un-in-habit-ed (2) |                                 |                            |                              |                      |                                 |                               | (1) Deaf-and-Dumb          | (2) Blind | (3) Imbecile or Idiot                | (4) Lunatic |
| 79                   | Chapel Lane                                 | 1                 |                    | Marg <sup>t</sup> Johnson       | Head                       | Widow                        | 69                   | Farmer of 31 acres              | North Meads Lanc <sup>r</sup> |                            |           |                                      |             |
|                      | do do                                       |                   |                    | Will <sup>m</sup> Strickland    | Son-in-law                 | Mar <sup>d</sup>             | 34                   | Ag Lab <sup>r</sup>             | Longton do                    |                            |           |                                      |             |
|                      | do do                                       |                   |                    | Marg <sup>t</sup> do            | Wife                       | do                           | 34                   | Dairy-mad ag <sup>t</sup>       | Hutton do                     |                            |           |                                      |             |
|                      | do do                                       |                   |                    | Thomas Holt                     | Man-serv                   | do                           | 13                   | Farm Servant                    | Longton do                    |                            |           |                                      |             |
|                      | do do                                       |                   |                    | Henry Walton                    | Serv                       | do                           | 17                   | do do                           | do do                         |                            |           |                                      |             |
| 80                   | do do                                       | 1                 |                    | George Bamford                  | Head                       | Mar <sup>d</sup>             | 71                   | Farmer of 5 acres               | do do                         |                            |           |                                      |             |
|                      | do do                                       |                   |                    | Marg <sup>t</sup> do            | Wife                       | do                           | 40                   | Wife ag <sup>t</sup>            | do do                         |                            |           |                                      |             |
|                      | do do                                       |                   |                    | Alice Mawdsley                  | Head                       | Unm                          | 17                   | do Servant                      | do do                         |                            |           |                                      |             |
| 81                   | do do                                       | 1                 |                    | Henry D <sup>r</sup> Briggs     | Head                       | Mar <sup>d</sup>             | 58                   | do Servant                      | Preston do                    |                            |           |                                      |             |
|                      | do do                                       |                   |                    | Jane do                         | Wife                       | do                           | 60                   | do Wife                         | Sittie Hood do                |                            |           |                                      |             |
|                      | do do                                       |                   |                    | Edward do                       | Son                        | Unm                          | 30                   | Farm Servant                    | Preston do                    |                            |           |                                      |             |
|                      | do do                                       |                   |                    | Richard do                      | do                         | do                           | 25                   | do do                           | Sittie Hood do                |                            |           |                                      |             |
|                      | do do                                       |                   |                    | Eliza do                        | daur                       | do                           | 21                   | Cotton Weaver                   | do do                         |                            |           |                                      |             |
|                      | do do                                       |                   |                    | Eliza Ellen do                  | grand do                   | do                           | 3                    | do do                           | Longton do                    |                            |           |                                      |             |
|                      | do do                                       |                   |                    | Betty Cotton                    | Serv                       | do                           | 61                   | Domestic Servant                | Sittie Hood do                |                            |           |                                      |             |
| 82                   | do do                                       | 1                 |                    | Obadiah Snape                   | Head                       | Mar <sup>d</sup>             | 74                   | Wheelwright                     | Wheatton do                   |                            |           |                                      |             |
|                      | do do                                       |                   |                    | Ruth do                         | Wife                       | do                           | 42                   | Draper                          | Longton do                    |                            |           |                                      |             |
| 83                   | do do                                       | 1                 |                    | Hugh Harrison                   | Head                       | do                           | 26                   | Chgo <sup>r</sup>               | do do                         |                            |           |                                      |             |
|                      | do do                                       |                   |                    | Jane do                         | Wife                       | do                           | 21                   | Wife                            | do do                         |                            |           |                                      |             |
|                      | do do                                       |                   |                    | Marg <sup>t</sup> Jane do       | Daur                       | do                           | 19                   | do                              | do do                         |                            |           |                                      |             |
| 84                   | do do                                       | 1                 |                    | John Bond                       | Head                       | Mar <sup>d</sup>             | 76                   | Wheelwright                     | Hesketh Bank do               |                            |           |                                      |             |
|                      | do do                                       |                   |                    | Margaret do                     | Wife                       | do                           | 80                   | Wife                            | Longton do                    |                            |           |                                      |             |
| 85                   | do do                                       | 1                 |                    | W <sup>m</sup> Beardsworth      | Head                       | do                           | 36                   | Grbger                          | do do                         |                            |           |                                      |             |
|                      | do do                                       |                   |                    | Margaret do                     | Wife                       | do                           | 36                   | do Wife                         | do do                         |                            |           |                                      |             |
| Total of Houses...   |   | 7                 |                    | Total of Males and Females...   |                            |                              |                      | 14                              | 10                            |                            |           |                                      |             |

NOTE—Draw the pen through such of the words of the headings as are inappropriate.

Eng— Sheet 11

|                      |   |   |   |   |   |              |
|----------------------|---|---|---|---|---|--------------|
| PUBLIC RECORD OFFICE |   |   |   |   |   | Reference:-  |
| 1                    | 2 | 3 | 4 | 5 | 6 | RG 11 / 4224 |
| 1                    |   |   |   |   |   |              |

COPYRIGHT PHOTOGRAPH - NOT TO BE REPRODUCED PHOTOGRAPHICALLY WITHOUT PERMISSION OF THE PUBLIC RECORD OFFICE, LONDON

The 1881 Census showing Elizabeth Ellen BRIGGS with her grandparents in Chapel Lane, Longton  
 RG 11 / 4224 / F. 11 / P. 15 / Sch. 81

Administrative County of Yorks The undermentioned Houses are situate within the Boundaries of the Praton Union of Blackpool of Pewortham Page 10

Civil Parish of Longton Municipal Borough of Blackpool Municipal Ward of Blackpool Urban-Sanitary-District of Blackpool Town or Village or Hamlet of Blackpool Rural Sanitary District of Blackpool Parliamentary Borough or Division of Blackpool Ecclesiastical Parish or District of Pewortham

| Col. 1          | 2  | 3      | 4                                    | 5  | 6                               | 7                          | 8                         | 9                    | 10                       | 11       | 12       | 13         | 14                          | 15  | 16 |
|-----------------|--|--------|--------------------------------------|--|---------------------------------|----------------------------|---------------------------|----------------------|--------------------------|----------|----------|------------|-----------------------------|---|----|
| No. of Schedule | ROAD, STREET, &c., and No. or NAME of HOUSE                    | HOUSES | Number of Tenements in Building (B.) | Number of rooms occupied by more than five persons | NAME and Surname of each Person | RELATION to Head of Family | CON-DITION as to Marriage | AGE last Birthday of | PROFESSION or OCCUPATION | Employer | Employed | Where Born | WHERE BORN                  | (1) Deaf-and-Dumb (2) Blind (3) Lame, Imbecile or Idiot |    |
| 59              | Chapel Lane  | 1      |                                      |  | George Bamford                  | Head                       | M                         | 81                   | Farmer                   |          |          | X          | Leicestershire, Longton     |   |    |
|                 |  |        |                                      |  | Margaret do                     | Wife                       | M                         | 80                   |                          |          |          |            | do do                       |   |    |
| 60              | do   | 1      |                                      |  | Elizabeth Briggs                | Head                       | S                         | 38                   | Cotton Weaver            |          |          | X          | do do                       |   |    |
|                 |  |        |                                      |  | Mary A. Moss                    | Sister                     | Wid                       | 33                   | Cotton Weaver            |          | X        |            | do Muelstole                |   |    |
|                 |  |        |                                      |  | Elizabeth E. Briggs             | Niece                      | S                         | 13                   |                          |          |          |            | do Longton                  |   |    |
|                 |  |        |                                      |  | Henry B. Moss                   | Nephew                     | S                         | 10                   | Scholar                  |          |          |            | do do                       |   |    |
|                 |  |        |                                      |  | Elizabeth Cotton                | Boarder                    | S                         | 71                   | Living on own means      |          |          |            | do Muelstole                |   |    |
| 61              | do   | 1      |                                      |  | Wladimir Snake                  | Head                       | M                         | 58                   | Printer                  |          | X        |            | do Whetton                  |   |    |
|                 |  |        |                                      |  | Harriet A. do                   | Wife                       | M                         | 47                   |                          |          |          |            | do Preston                  |   |    |
| 62              | do   | 1      |                                      |  | James Gill                      | Head                       | M                         | 22                   | Portman on Railway       |          | X        |            | do Muelstole                |   |    |
|                 |  |        |                                      |  | Elizabeth do                    | Wife                       | M                         | 21                   | Cotton Weaver            |          | X        |            | do Longton                  |   |    |
| 63              | do   | 1      |                                      |  | John Harrison                   | Head                       | M                         | 71                   | Farm Laborer             |          | X        |            | do Muelstole                |   |    |
|                 |  |        |                                      |  | Jane do                         | Wife                       | M                         | 69                   |                          |          |          |            | do do                       |   |    |
|                 |  |        |                                      |  | Ann Lombard                     | Daughter                   | S                         | 26                   |                          |          |          |            | do do                       |   |    |
|                 |  |        |                                      |  | Grace Harrison                  | Daughter                   | S                         | 24                   | Cotton Weaver            |          | X        |            | do Longton                  |   |    |
|                 |  |        |                                      |  | Mary J. do                      | Daughter                   | S                         | 23                   | Cotton Weaver            |          | X        |            | do do                       |   |    |
|                 |  |        |                                      |  | Margaret J. Lombard             | Daughter                   | S                         | 16                   | Domestic's Apprentice    |          | X        |            | do do                       |   |    |
| 64              | do   | 1      |                                      |  | John Wade                       | Head                       | M                         | 41                   | Printer                  |          | X        |            | do do                       |   |    |
|                 |  |        |                                      |  | Margaret do                     | Wife                       | M                         | 44                   | Greener                  |          |          |            | do do                       |   |    |
|                 |  |        |                                      |  | Margaret do                     | Daughter                   | S                         | 14                   | Scholar                  |          |          |            | do do                       |   |    |
| 65              | do   | 1      |                                      |  | Thomas Riding                   | Head                       | Wid                       | 48                   | Builder & Farmer         |          | X        |            | do do                       |   |    |
|                 |  |        |                                      |  | William do                      | Son                        | M                         | 14                   | Bricklayer               |          | X        |            | do do                       |   |    |
|                 |  |        |                                      |  | Mary do                         | Daughter                   | S                         | 13                   | Farmer's Daughter        |          |          |            | do do                       |   |    |
|                 |  |        |                                      |  | Ada E. do                       | Daughter                   | S                         | 11                   | Scholar                  |          |          |            | do do                       |   |    |
|                 |  |        |                                      |  | June do                         | Daughter                   | S                         | 9                    | Scholar                  |          |          |            | do do                       |   |    |
| 66              | School Lane  | 1      |                                      |  | Edward Pawcliffe                | Head                       | Wid                       | 81                   |                          |          |          | X          | do do                       |   |    |
|                 |  |        |                                      |  | Edward do                       | Grandson                   | S                         | 20                   | Carrier for bricklayer   |          | X        |            | do Rufford                  |   |    |
|                 |  |        |                                      |  | James do                        | Grandson                   | S                         | 15                   | Railway Servant          |          | X        |            | do do                       |   |    |
| 67              | do   | 1      |                                      |  | Herbert Foster                  | Head                       | M                         | 39                   | Croftman, Gardener, &c.  |          | X        |            | Leicestershire, Longborough |   |    |
|                 |  |        |                                      |  | Kate do                         | Wife                       | M                         | 36                   |                          |          |          |            | Worcestershire, Chiffeld    |   |    |
| 9               | Total of Houses and of Tenements with less than Five Rooms ... | 9      | 1                                    |  | Total of Males and Females...   |                            | 13                        | 22                   |                          |          |          |            |                             |   |    |

Note.—Draw the pen through such of the words of the headings as are inappropriate.

PUBLIC RECORD OFFICE

Reference: **RG12/3428**

COPYRIGHT - NOT TO BE REPRODUCED PHOTOGRAPHICALLY WITHOUT PERMISSION

The 1891 Census showing Elizabeth E. BRIGGS living in Chapel Lane, Longton, with her aunt  
 RG 12 / 3428 / F. 65 / P. 10 / Sch. 60

In the results below, the reference number will be a link. Clicking on this link will add your choice to a summary list on a new page. From this [summary page](#) you will be able to review all your search results and you will find links to printable application forms which can be used to order the certificate for the index entry. Full details of the charges and the Register Office address can be found on the form.

## Lancashire Birth indexes for the years: 1897

| Surname | Forename(s) | Sub-District | Registers At | Mother's Maiden Name | Reference                  |
|---------|-------------|--------------|--------------|----------------------|----------------------------|
| BRIGGS  | Richard     | Longton      | Preston      | BRIGGS               | <a href="#">LONG/26/26</a> |

Total records matching : 1.

**No matching records were found for Richard BRIGGS in the following years:**  
1898, 1899

If you haven't found the **Richard BRIGGS** that you're looking for, it may be that the indexes for your area of interest have not been transcribed yet. See our [coverage page](#) for more information.

**Many other** counties have their BMD indexes on-line. If you can't find the entry in this area, perhaps you could try a neighbouring area. See the **Local BMD** section of Information regarding the purchase of certificates can be found in the [Birth Information](#) page.



Click on the appropriate reference number in the tables above to add your choice to your [summary page](#). From the summary page you will be able to review all your search choices and print off application forms to order copy certificates.

**NOTE:** Each Region's Register Office has a different address. Please be sure to send your application to the correct office, otherwise your application may be rejected.

The appropriate address will be found near the bottom of the application form.



The Parish of Hoole  
in the County of  
-- Lancashire --

Baptism: 14 Nov 1897 St Michael, Hoole,  
Lancashire, England

Richard Briggs - Son of Elizabeth Ellen Briggs

Born: 21 Sep 1897

Abode: Little Hoole

Notes: Spinster

Baptised by: E.N.Dunne Rector

Register: Baptisms 1836 - 1900, Page 188,  
Entry 1502

Source: LDS Film 1471151



The Parish of Tarleton  
in the County of  
-- Lancashire --

Baptism: 5 Jan 1873 St Mary, Tarleton,  
Lancashire, England

James Forshaw - [Child] of Jane Forshaw, Single  
Woman

Abode: Tarleton

Baptised by: M. Fletcher Rector

Register: Baptisms 1839 - 1888, Page 221,  
Entry 1762

Source: LDS Film 1278941



The Parish of Hoole  
in the County of  
-- Lancashire --

Banns: Holy Trinity, Tarleton, Lancashire, England

James Forshaw - Bachelor, of this parish

Elizabeth Ellen Briggs - Spinster, Hoole

First Reading: 6 Feb 1898; Read By: Robert C. Fletcher

Second Reading: 13 Feb 1898; Read By: Robert C. Fletcher

Third Reading: 20 Feb 1898; Read By: Robert C. Fletcher

Register: Banns 1880 - 1900, Page 48, Entry 143

Source: LDS Film 1278942

Banns: St Michael, Hoole, Lancashire, England

James Forshaw - the Parish of Tarleton

Elizabeth Ellen Briggs - this Parish

First Reading: 6 Feb 1898; Read By: E. N. Dunne

Second Reading: 13 Feb 1898; Read By: E. N. D.

Third Reading: 20 Feb 1898; Read By: E. N. D.

Notes: Married Feb 23 1898

Register: Banns 1870 - 1900, Page 58, Entry -

Source: LDS Film 1471151

Marriage: 23 Feb 1898 St Michael, Hoole, Lancashire, England

James Forshaw - 25, Farm Labourer, Bachelor, Tarleton

Elizabeth Ellen Briggs - 20, Spinster, Little Hoole

Witness: William Silcock; Ann Wilding

Married by Banns by: Edmund N. Dunne Rector

Notes: [Bride and Groom's Fathers' Names and Occupations not shown]

Register: Marriages 1870 - 1900, Page 152, Entry 304

Source: LDS Film 1471151

| Administrative County |   | LANCASTER.            |             |  |                   |  |                                  |                            |     |                                   |                          | The undermentioned Houses are situate within the boundaries of the |                    |                         |  |    | Page 5 |
|-----------------------|---|-----------------------|-------------|--|-------------------|--|----------------------------------|----------------------------|-----|-----------------------------------|--------------------------|--|--------------------|-------------------------|--|----|--------|
| Civil Parish          |   | Ecclesiastical Parish |             | County Borough, Municipal Borough, or Urban District |                   | Ward of Municipal Borough or of Urban District |                                  | Rural District             |     | Parliamentary Borough or Division |                          | Town or Village or Hamlet  |                    |                         |  |    |        |
| of Little Hoole       |   | of Little Hoole       |             | of   |                   | of   |                                  | of Preston                 |     | of Blackpool                      |                          | of Walmer Bridge   |                    |                         |  |    |        |
| Cols 1                | 2   | HOUSES                |             |  |                   | 8  | 9                                | 10                         | 11  |                                   | 13                       | 14   | 15                 | 16                      | 17   |    |        |
|                       |   | 3                     | 4           | 5  | 6                 |  |                                  |                            | 7   | 10                                |                          |  |                    |                         |  | 11 |        |
| No. of Schedules      | ROAD, STREET &c. and No. or NAME of HOUSE                               | Inhabited             | Uninhabited | In Occupation  | Not in Occupation | Building                                       | Name and Surname of each Person  | RELATION to Head of Family | Sex | Age last Birthday of              | PROFESSION OR OCCUPATION | Employer, Worker, or Own account                                   | If Working at Home | WHERE BORN              | If (1) Deaf and Dumb (2) Blind (3) Lunatic (4) Imbecile, feeble-minded |    |        |
| 27                    | School St<br>do   | 1                     |             |  |                   |  | Thomas Tomkinson                 | Victor                     | M   | 2                                 |                          |  |                    | Lancashire Little Hoole |  |    |        |
|                       |   |                       |             |  |                   |  | Ann Tomkinson                    | Head                       | S   | 50                                |                          |  |                    | do Bamberley            |  |    |        |
|                       |   |                       |             |  |                   |  | Jane do                          | Daughter                   | S   | 20                                |                          |  |                    | do do                   |  |    |        |
|                       |   |                       |             |  |                   |  | Margaret do                      | Daughter                   | S   | 10                                | Cotton Weaver            | Worker   |                    | do do                   |  |    |        |
| 28                    | do  | 1                     |             |  |                   |  | Mary E Higham                    | Head                       | M   | 42                                |                          |  |                    | do Longton              |  |    |        |
|                       |   |                       |             |  |                   |  | John Webster                     | Head                       | M   | 42                                | Cotton Weaver            | Worker   |                    | do do                   |  |    |        |
|                       |   |                       |             |  |                   |  | Elizabeth do                     | Wife                       | M   | 33                                |                          |  |                    | do Hutton               |  |    |        |
|                       |   |                       |             |  |                   |  | James do                         | Son                        | M   | 12                                | Cotton Weaver            | Worker   |                    | do Little Hoole         |  |    |        |
|                       |   |                       |             |  |                   |  | Thomas do                        | Son                        | M   | 9                                 |                          |  |                    | do Longton              |  |    |        |
|                       |   |                       |             |  |                   |  | William do                       | Son                        | M   | 6                                 |                          |  |                    | do Little Hoole         |  |    |        |
|                       |   |                       |             |  |                   |  | Richard do                       | Son                        | M   | 1                                 |                          |  |                    | do do                   |  |    |        |
| 29                    | Sea View  | 1                     |             |  |                   |  | Mary do                          | Daughter                   | F   | 4 mo                              |                          |  |                    | do do                   |  |    |        |
|                       |   |                       |             |  |                   |  | Richard Parker                   | Head                       | M   | 53                                | Farm Labourer            | Worker   |                    | do Hoole                |  |    |        |
|                       |   |                       |             |  |                   |  | Mary do                          | Wife                       | M   | 55                                |                          |  |                    | do do                   |  |    |        |
|                       |   |                       |             |  |                   |  | Alice do                         | Daughter                   | S   | 21                                | Cotton Weaver            | Worker   |                    | do do                   |  |    |        |
|                       |   |                       |             |  |                   |  | Jane do                          | Daughter                   | S   | 19                                | do                       | do   |                    | do do                   |  |    |        |
|                       |   |                       |             |  |                   |  | Mary do                          | Daughter                   | S   | 17                                | do                       | do   |                    | do do                   |  |    |        |
| 30                    |   | 1                     |             |  |                   |  | George do                        | Son                        | M   | 14                                | do                       | do   |                    | do do                   |  |    |        |
|                       |   |                       |             |  |                   |  | Hy Chadwick                      | Head                       | M   | 40                                | Lape Lizer (Cotton)      | do   |                    | do Much Hoole           |  |    |        |
|                       |   |                       |             |  |                   |  | Bethie do                        | Wife                       | M   | 43                                | Cotton Weaver            | do   |                    | do Longton              |  |    |        |
| 31                    |   | 1                     |             |  |                   |  | Alice Parker                     | S-in-law                   | S   | 46                                | do                       | do   |                    | do do                   |  |    |        |
|                       |   |                       |             |  |                   |  | Richard Harrison                 | Head                       | M   | 38                                | Brick Labourer           | do   |                    | do do                   |  |    |        |
|                       |   |                       |             |  |                   |  | Alice do                         | Wife                       | M   | 44                                |                          |  |                    | do Bamberley            |  |    |        |
|                       |   |                       |             |  |                   |  | Margaret do                      | Daughter                   | S   | 17                                | Cotton Weaver            | Worker   |                    | do do                   |  |    |        |
|                       |   |                       |             |  |                   |  | Thomas do                        | Son                        | M   | 15                                | Brick Labourer           | do   |                    | do do                   |  |    |        |
|                       |   |                       |             |  |                   |  | William do                       | Son                        | M   | 13                                | do                       | do   |                    | do do                   |  |    |        |
|                       |   |                       |             |  |                   |  | James do                         | Son                        | M   | 11                                | do                       | do   |                    | do do                   |  |    |        |
|                       |   |                       |             |  |                   |  | Hugh do                          | Son                        | M   | 6                                 | do                       | do   |                    | do do                   |  |    |        |
| 32                    |   | 1                     |             |  |                   |  | Richard do                       | Son                        | M   | 3                                 |                          |  |                    | do do                   |  |    |        |
|                       |   |                       |             |  |                   |  | Mary Moss                        | Head                       | F   | 43                                | Cotton Weaver            | Worker   |                    | do Little Hoole         |  |    |        |
|                       |   |                       |             |  |                   |  | Richard Briggs                   | Son                        | M   | 3                                 |                          |  |                    | do do                   |  |    |        |
| 6                     | Total of Schedules of Houses and of Tenements with less than Five Rooms | 6                     |             |  |                   |  | Total of Males and of Females... |                            |     | 15                                | 16                       |  |                    |                         |  |    |        |

NOTE—Draw your pen through such words of the headings as are inapplicable.

The 1901 Census shows Richard Briggs aged 3, with grandmother at Sea View, Little Hoole  
 RG 13 / 3942 / F. 111 / P. 5 / Sch. 32

| Administrative County |   | LANCASTER.            |             | The undermentioned Houses are situate within the boundaries of the |                                  |                            |  |                      |        |                          |                                  |                                   |            |                           |  |        |
|-----------------------|---|-----------------------|-------------|--|----------------------------------|----------------------------|--|----------------------|--------|--------------------------|----------------------------------|-----------------------------------|------------|---------------------------|--|--------|
| Civil Parish          |   | Ecclesiastical Parish |             | County Borough, Municipal Borough, or Urban District               |                                  |                            | Ward of Municipal Borough or of Urban District |                      |        | Rural District           |                                  | Parliamentary Borough or Division |            | Town or Village or Hamlet |  | Page 5 |
| of Little Hooles      |   | of Hoole St Michael   |             | of   |                                  |                            | of Preston                                     |                      |        | of Blackpool             |                                  | of Holmes Bridge                  |            |                           |  |        |
| No. of Schedules      | ROAD, STREET, &c. and No. or NAME of HOUSE                              | HOUSES                |             |  | Name and Surnames of each Person | RELATION to Head of Family | Condition as to Marriage                       | Age last Birthday of |        | PROFESSION OR OCCUPATION | Employer, Worker, or Own account | If Working at Home                | WHERE BORN |                           | (1) Deaf and Dumb<br>(2) Blind<br>(3) Lunatic<br>(4) Imbecile, feeble-minded |        |
|                       |   | Inhabited             | Uninhabited | Number of Rooms in House   |                                  |                            |  | Male                 | Female |                          |                                  |                                   | 15         | 16                        |  | 17     |
| 441                   | Rawcliffe Row   | 1                     |             |  | Even Porter                      | Head                       | M  | 22                   |        | Ag. Labr                 | Worker                           |                                   | Lancashire | Huddersfield              |  |        |
| 442                   | do  | 1                     |             |  | Elizabeth do                     | Wife                       | M  | 25                   |        | Cotton Weaver            | do                               |                                   | do         | Colton                    |  |        |
|                       |   |                       |             |  | William Widding                  | Head                       | M  | 58                   |        | do do                    | do                               |                                   | do         | Farrington                |  |        |
|                       |   |                       |             |  | Catherine do                     | Wife                       | M  | 58                   |        | do do                    | do                               |                                   | do         | Loughton                  |  |        |
| 443                   | do  | 1                     |             |  | Ann do                           | Serv                       | S  | 23                   |        | Cotton Weaver            | Worker                           |                                   | do         | do                        |  |        |
|                       |   |                       |             |  | Thomas Wilson                    | Head                       | M  | 25                   |        | Blacksmith               | do                               |                                   | do         | Hoole                     |  |        |
| 444                   | do  | 1                     |             |  | Ellen do                         | Wife                       | M  | 24                   |        | Cotton Weaver            | do                               |                                   | do         | Little Hooles             |  |        |
|                       |   |                       |             |  | James Forshaw                    | Head                       | M  | 28                   |        | Blacksmith Navy          | do                               |                                   | do         | Falton                    |  |        |
|                       |   |                       |             |  | Elizabeth do                     | Wife                       | M  | 23                   |        | do                       | do                               |                                   | do         | Loughton                  |  |        |
| 445                   | do  | 1                     |             |  | Arthur do                        | Son                        |  | 1                    |        | do                       | do                               |                                   | do         | Little Hooles             |  |        |
|                       |   |                       |             |  | Margaret Sumner                  | Head                       | S  | 60                   |        | do                       | do                               |                                   | do         | Burtholme                 |  |        |
|                       |   |                       |             |  | Sarah do                         | Serv                       | S  | 28                   |        | Cotton Weaver            | Worker                           |                                   | do         | Little Hooles             |  |        |
| 446                   | do  | 1                     |             |  | Edward Wignall                   | Serv                       |  | 6                    |        | do                       | do                               |                                   | do         | Loughton                  |  |        |
|                       |   |                       |             |  | Betty Sharp                      | Head                       | Wid  | 51                   |        | do                       | do                               |                                   | do         | Muswell Hill              |  |        |
|                       |   |                       |             |  | Jane Alice do                    | Serv                       | S  | 27                   |        | Cotton Weaver            | Worker                           |                                   | do         | do                        |  |        |
|                       |   |                       |             |  | Ellen do                         | Serv                       | S  | 17                   |        | do do                    | do                               |                                   | do         | Little Hooles             |  |        |
| 447                   | do  | 1                     |             |  | Liz Greenwood                    | Boarder                    | S  | 29                   |        | do do                    | do                               |                                   | York       | Eastwood                  |  |        |
|                       |   |                       |             |  | Robert Hindle                    | Head                       | Wid  | 56                   |        | Woolworker Cotton Mill   | do                               |                                   | Lancashire | Little Hooles             |  |        |
|                       |   |                       |             |  | Margaret do                      | Serv                       | S  | 27                   |        | Cotton Weaver            | do                               |                                   | do         | do                        |  |        |
|                       |   |                       |             |  | Jane Alice do                    | Serv                       | S  | 21                   |        | do do                    | do                               |                                   | do         | do                        |  |        |
| 448                   | do  | 1                     |             |  | Charles do                       | Son                        | S  | 16                   |        | do do                    | do                               |                                   | do         | do                        |  |        |
|                       |   |                       |             |  | Richard Wright                   | Head                       | M  | 68                   |        | Farmer                   | own account                      |                                   | do         | Falton                    |  |        |
|                       |   |                       |             |  | Peggy do                         | Wife                       | M  | 63                   |        | do                       | do                               |                                   | do         | Louthport                 |  |        |
|                       |   |                       |             |  | Hugh do                          | Son                        | S  | 31                   |        | Farmer                   | do                               |                                   | do         | Hoole                     |  |        |
| 449                   | do  | 1                     |             |  | Mary Seed                        | Serv                       | S  | 16                   |        | do                       | do                               |                                   | do         | do                        |  |        |
|                       |   |                       |             |  | James Wright                     | Head                       | M  | 39                   |        | Teamman                  | Worker                           |                                   | do         | do                        |  |        |
|                       |   |                       |             |  | Margaret do                      | Wife                       | M  | 37                   |        | do                       | do                               |                                   | do         | do                        |  |        |
|                       |   |                       |             |  | Ellen do                         | Serv                       |  | 12                   |        | do                       | do                               |                                   | do         | do                        |  |        |
|                       |   |                       |             |  | Alice do                         | Serv                       |  | 9                    |        | do                       | do                               |                                   | do         | do                        |  |        |
|                       |   |                       |             |  | Elizabeth do                     | Serv                       |  | 6                    |        | do                       | do                               |                                   | do         | do                        |  |        |
|                       |   |                       |             |  | Richard do                       | Son                        |  | 4                    |        | do                       | do                               |                                   | do         | do                        |  |        |
| 9                     | Total of Schedules of Houses and of Tenements with less than Five Rooms | 9                     |             |  | Total of Males and of Females... |                            |  | 18                   | 19     |                          |                                  |                                   |            |                           |  |        |

NOTE—Draw your pen through such words of the headings as are inapplicable.

The 1901 Census now showing the married Elizabeth E. FORSHAW in Little Hooles  
 RG 13 / 3942 / F. 112 / P. 7 / Sch. 44



# CENSUS OF ENGLAND AND WALES, 1911.

Number of Schedule 47  
(To be filled up by the Enumerator after collection.)

*Before writing on this Schedule please read the Examples and the Instructions given on the other side of the paper, as well as the headings of the Columns. The entries should be written in Ink.*

*The contents of the Schedule will be treated as confidential. Strict care will be taken that no information is disclosed with regard to individual persons. The returns are not to be used for proof of age, as in connection with Old Age Pensions, or for any other purpose than the preparation of Statistical Tables.*

| NAME AND SURNAME<br><br>of every Person, whether Member of Family, Visitor, Boarder, or Servant, who<br><br>(1) passed the night of Sunday, April 2nd, 1911, in this dwelling and was alive at midnight, or<br><br>(2) arrived in this dwelling on the morning of Monday, April 3rd, not having been enumerated elsewhere.<br><br>No one else must be included.<br><br>(For order of entering names see Examples on back of Schedule.) | RELATIONSHIP to Head of Family. | AGE (last Birthday) and SEX.   |                | PARTICULARS as to MARRIAGE. |  |   |                            |                        | PROFESSION or OCCUPATION of Persons aged ten years and upwards. |                      |   | BIRTHPLACE of every person. | NATIONALITY of every Person born in a Foreign Country. | INFIRMITY. |
|--|---------------------------------|--|----------------|-----------------------------|--|---|----------------------------|------------------------|---|----------------------|---|-----------------------------|--|------------|
|  |                                 | For Infants under one year state the age in months as "under one month," "one month," etc. | Ages of Males. | Ages of Females.            | Write "Single," "Married," "Widower," or "Widow," opposite the names of all persons aged 15 years and upwards. | Completed years the present Marriage has lasted. If less than one year write "under one." | Total Children Born Alive. | Children still Living. | Children who have Died.   | Personal Occupation. | Industry or Service with which worker is connected. |                             |  |            |
| 1 James Forshaw  | Head                            | 3  | 8              |                             |  |   |                            |                        | Plate Layer 51 1/2  | Railway              | Worth   | Tarleton Lancs              |  | None       |
| 2 Elizabeth E Forshaw  | Wife                            | 33   |                | married                     | 13   | 4   | 3                          | 1                      |   |                      |   | Longton "                   |  |            |
| 3 Arthur Forshaw   | Son                             | 11   |                |                             |  |   |                            |                        | School 390  |                      | 0   | " "                         |  |            |
| 4 Mary Edith Forshaw   | Daughter                        | 8  |                |                             |  |   |                            |                        |   |                      |   | Preston "                   | 062  |            |
| 5  |                                 |  |                |                             |  |   |                            |                        |   |                      |   |                             |  |            |
| 6  |                                 |  |                |                             |  |   |                            |                        |   |                      |   |                             |  |            |
| 7  |                                 |  |                |                             |  |   |                            |                        |   |                      |   |                             |  |            |
| 8  |                                 |  |                |                             |  |   |                            |                        |   |                      |   |                             |  |            |
| 9  |                                 |  |                |                             |  |   |                            |                        |   |                      |   |                             |  |            |
| 10   |                                 |  |                |                             |  |   |                            |                        |   |                      |   |                             |  |            |
| 11   |                                 |  |                |                             |  |   |                            |                        |   |                      |   |                             |  |            |
| 12   |                                 |  |                |                             |  |   |                            |                        |   |                      |   |                             |  |            |
| 13   |                                 |  |                |                             |  |   |                            |                        |   |                      |   |                             |  |            |
| 14   |                                 |  |                |                             |  |   |                            |                        |   |                      |   |                             |  |            |
| 15   |                                 |  |                |                             |  |   |                            |                        |   |                      |   |                             |  |            |

(To be filled up by the Enumerator.)

|  |        |          |          |
|--|--------|----------|----------|
| I certify that :-<br>(1) All the ages on this Schedule are entered in the proper sex columns.<br>(2) I have counted the males and females in Columns 3 and 4 separately, and have compared their sum with the total number of persons.<br>(3) After making the necessary enquiries I have completed all entries on the Schedule which appeared to be defective, and have corrected such as appeared to be erroneous. | Total. |          |          |
|  | Males. | Females. | Persons. |
| Initials of Enumerator <i>J.M.</i>   | 2      | 2        | 4        |

(To be filled up by, or on behalf of, the Head of Family or other person in occupation, or in charge, of this dwelling.)

|   |  |
|---|--|
| <p>Write below the Number of Rooms in this Dwelling (House, Tenement, or Apartment). Count the kitchen as a room but do not count scullery, landing, lobby, closet, bathroom; nor warehouse, office, shop.</p> <p style="text-align: center; font-size: 2em;">4</p> | <p>I declare that this Schedule is correctly filled up to the best of my knowledge and belief.</p> <p style="text-align: right;">Signature <i>James Forshaw</i></p> <p style="text-align: right;">Postal Address <i>Rawcliffe Row, Walmer Bridge</i></p> |
|---|--|

**The 1911 Census with Elizabeth Ellen FORSHAW and family in Rawcliffe Row, Walmer Bridge  
RG 14 \_ 25240 \_ 0093 \_ 03**

# CENSUS OF ENGLAND AND WALES, 1911.

Number of Schedule 42  
(To be filled up by the Enumerator after collection.)

*Before writing on this Schedule please read the Examples and the Instructions given on the other side of the paper, as well as the headings of the Columns. The entries should be written in Ink.*

*The contents of the Schedule will be treated as confidential. Strict care will be taken that no information is disclosed with regard to individual persons. The returns are not to be used for proof of age, as in connection with Old Age Pensions, or for any other purpose than the preparation of Statistical Tables.*

| NAME AND SURNAME   | RELATIONSHIP to Head of Family.  | AGE (last Birthday) and SEX.   |                | PARTICULARS as to MARRIAGE. |  |   |  |                            | PROFESSION or OCCUPATION of Persons aged ten years and upwards. |                         |  |  | BIRTHPLACE of every person.   | NATIONALITY of every Person born in a Foreign Country.  | INFIRMITY.  |   |   |
|--|--|--|----------------|-----------------------------|--|---|--|----------------------------|---|-------------------------|--|--|---|---|---|---|---|
|  |  | For Infants under one year state the age in months as "under one month," "one month," etc. | Ages of Males. | Ages of Females.            | Write "Single," "Married," "Widower," or "Widow," opposite the names of all persons aged 15 years and upwards. | Completed years the present Marriage has lasted. If less than one year write "under one." | Children born alive to present Marriage. (If no children born alive write "None" in Column 7). | Total Children Born Alive. | Children still Living.  | Children who have Died. | Personal Occupation.   | Industry or Service with which worker is connected.  |   |   |   | Whether Employer, Worker, or Working on Own Account.  | Whether Working at Home.  |
| of every Person, whether Member of Family, Visitor, Boarder, or Servant, who<br><br>(1) passed the night of Sunday, April 2nd, 1911, in this dwelling and was alive at midnight, or<br><br>(2) arrived in this dwelling on the morning of Monday, April 3rd, not having been enumerated elsewhere.<br><br>No one else must be included.<br><br>(For order of entering names see Examples on back of Schedule.) | State whether "Head," or "Wife," "Son," "Daughter," or other Relative, "Visitor," "Boarder," or "Servant." | For Infants under one year state the age in months as "under one month," "one month," etc. | Ages of Males. | Ages of Females.            | Write "Single," "Married," "Widower," or "Widow," opposite the names of all persons aged 15 years and upwards. | Completed years the present Marriage has lasted. If less than one year write "under one." | Children born alive to present Marriage. (If no children born alive write "None" in Column 7). | Total Children Born Alive. | Children still Living.  | Children who have Died. | Personal Occupation.<br><br>The reply should show the precise branch of Profession, Trade, Manufacture, &c.<br><br>If engaged in any Trade or Manufacture, the particular kind of work done, and the Article made or Material worked or dealt in should be clearly indicated.<br><br>(See Instructions 1 to 8 and Examples on back of Schedule.) | Industry or Service with which worker is connected.<br><br>This question should generally be answered by stating the business carried on by the employer. If this is clearly shown in Col. 10 the question need not be answered here.<br><br>No entry needed for Domestic Servants in private employment. If employed by a public body (Government, Municipal, etc.) state what body.<br><br>(See Instruction 9 and Examples on back of Schedule.) | Whether Employer, Worker, or Working on Own Account.<br><br>Write opposite the name of each person engaged in any Trade or Industry,<br>(1) "Employer" (that is employing persons other than domestic servants), or<br>(2) "Worker" (that is working for an employer), or<br>(3) "Own Account" (that is neither employing others nor working for a trade employer). | Whether Working at Home.<br><br>Write the words "At Home" opposite the name of each person carrying on Trade or Industry at home. | (1) If born in the United Kingdom, write the name of the County, and Town or Parish.<br><br>(2) If born in any other part of the British Empire, write the name of the Dependency, Colony, etc., and of the Province or State.<br><br>(3) If born in a Foreign Country, write the name of the Country.<br><br>(4) If born at sea, write "At Sea." | State whether:—<br>(1) "British subject by parentage."<br>(2) "Naturalised British subject," giving year of naturalisation.<br><br>Or<br>(3) If of foreign nationality, state whether "French," "German," "Russian," etc. | If any person included in this Schedule is:—<br>(1) "Totally Deaf" or "Deaf and Dumb,"<br>(2) "Totally Blind,"<br>(3) "Lunatic,"<br>(4) "Imbecile," or "Feeble-minded," state the infirmity opposite that person's name, and the age at which he or she became afflicted. |
| 1.   | 2.   | 3.   | 4.             | 5.                          | 6.   | 7.  | 8.   | 9.                         | 10.   | 11.                     | 12.  | 13.  | 14.   | 15.   | 16.   |   |   |
| 1  | Mary Ellice Gross  | Head   |                | 53                          | Widow  |   |  |                            |   |                         |  |  | Little Hoole, Lanes   |   |   |   |   |
| 2  | Richard Briggs   | Grandson   | 13             |                             |  |   |  |                            |   | Team Labourer           | Worker   |  | Little Hoole "  |   |   |   |   |
| 3  |  |  |                |                             |  |   |  |                            |   |                         |  |  |   |   |   |   |   |
| 4  |  |  |                |                             |  |   |  |                            |   |                         |  |  |   |   |   |   |   |
| 5  |  |  |                |                             |  |   |  |                            |   |                         |  |  |   |   |   |   |   |
| 6  |  |  |                |                             |  |   |  |                            |   |                         |  |  |   |   |   |   |   |
| 7  |  |  |                |                             |  |   |  |                            |   |                         |  |  |   |   |   |   |   |
| 8  |  |  |                |                             |  |   |  |                            |   |                         |  |  |   |   |   |   |   |
| 9  |  |  |                |                             |  |   |  |                            |   |                         |  |  |   |   |   |   |   |
| 10   |  |  |                |                             |  |   |  |                            |   |                         |  |  |   |   |   |   |   |
| 11   |  |  |                |                             |  |   |  |                            |   |                         |  |  |   |   |   |   |   |
| 12   |  |  |                |                             |  |   |  |                            |   |                         |  |  |   |   |   |   |   |
| 13   |  |  |                |                             |  |   |  |                            |   |                         |  |  |   |   |   |   |   |
| 14   |  |  |                |                             |  |   |  |                            |   |                         |  |  |   |   |   |   |   |
| 15   |  |  |                |                             |  |   |  |                            |   |                         |  |  |   |   |   |   |   |

(To be filled up by the Enumerator.)

|   |        |
|---|--------|
| I certify that:—<br>(1) All the ages on this Schedule are entered in the proper sex columns.<br>(2) I have counted the males and females in Columns 3 and 4 separately, and have compared their sum with the total number of persons.<br>(3) After making the necessary enquiries I have completed all entries on the Schedule which appeared to be defective, and have corrected such as appeared to be erroneous. | Total. |
| Males. Females. Persons.  | 1 1 2  |
| Initials of Enumerator  | J.M.   |

(To be filled up by, or on behalf of, the Head of Family or other person in occupation, or in charge, of this dwelling.)

|   |   |
|---|---|
| Write below the Number of Rooms in this Dwelling (House, Tenement, or Apartment). Count the kitchen as a room but do not count scullery, landing, lobby, closet, bathroom; nor warehouse, office, shop. | 5   |
| I declare that this Schedule is correctly filled up to the best of my knowledge and belief.   | Signature <u>Mary Ellice Gross</u><br><u>Rawcliffe Row</u><br>Postal Address <u>Liverpool Rd Little Hoole</u> |

**Richard BRIGGS aged 13 in the 1911 Census with his grandmother at Rawcliffe Row, Liverpool Road, Little Hoole**  
**RG 14 \_ 25240 \_ 0083 \_ 03**

Edward BRIGGS m. ???

!

Henry Dawson BRIGGS  
b. 1823 Preston

!

!

!

Mary

Alice

b. 1858

Hoole

!

!

!

Elizabeth

Ellen

b. 1877

Longton

!

bap. 12 Aug 1877

St. Michael's

Hoole

!

Richard BRIGGS

b. 1897

Little Hoole

!

bap. 14 Nov 1897

St. Michael's

Hoole

!

Killed in Action

7 Aug 1917

James MEE m. ???

!

Jane MEE

b. 1821 Little Hoole

!

!

!

Elizabeth

!

b. 1860

Little Hoole

Thomas Rawcliffe and Alice Moss

!

m. 1880

James Moss b. 1855 (c) Longton

Penwortham

St. Mary's

!

Henry Briggs

b. 1901

Longton

m. 1849

Preston

St. John

Edward

!

b. 1851

Preston

Richard

!

b. 1856

Little Hoole

m. 1898

James

Forshaw

St. Michael's

Hoole

!

!

Arthur

William

b. 1899

Longton

Henry

b. 1901

Longton

Mary

Edith

b. 1902

Trinity,

Preston